

INSTRUCTION SHEET

OFF VEHICLE CARBURETOR SERVICE

AISAN 2 BARREL

50-716-1

GENERAL EXPLODED VIEW

THE GENERAL DESIGN AND PARTS SHOWN WILL VARY TO INDIVIDUAL UNITS COVERED ON THIS INSTRUCTION SHEET.

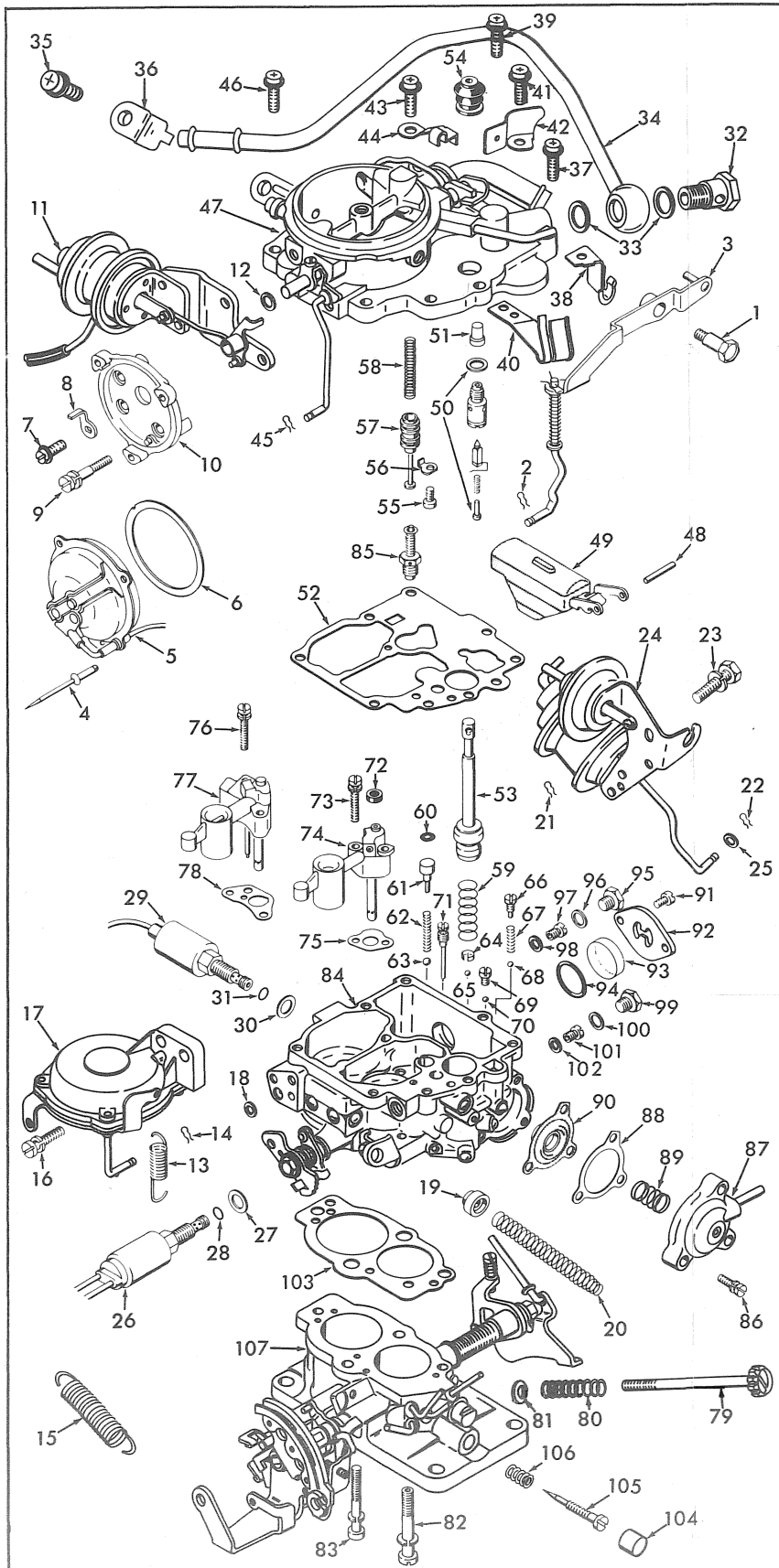

DISASSEMBLY

USE EXPLODED VIEW AS A GUIDE. THE NUMERICAL SEQUENCE MAY GENERALLY BE FOLLOWED TO DISASSEMBLE UNIT FAR ENOUGH TO PERMIT CLEANING AND INSPECTION. NOTE: TO REMOVE TAMPER RESISTANT RETAINER FROM CHOKE COVER, CAREFULLY DRILL RIVET HEADS OFF. REMOVE CHOKE COMPONENTS THEN KNOCK OUT REMAINDER OF RIVETS. DISASSEMBLY OF SECONDARY VACUUM UNIT (19) IS NOT NECESSARY UNLESS DIAPHRAGM IS BEING REPLACED. TO REMOVE IDLE MIXTURE NEEDLE PLUG, CENTER PUNCH CENTER OF PLUG, CAREFULLY DRILL A .255" HOLE IN PLUG. (NOTE THERE IS ONLY .040" CLEARANCE BETWEEN PLUG AND MIXTURE SCREW.) PRY REMAINDER OF PLUG FROM HOLE.

NOMENCLATURE

REF. NO.	REF. NO.
1. SCREW - PUMP LEVER	55. SCREW & LOCKWASHER - PISTON RETAINER
2. RETAINER - PUMP ROD	56. RETAINER - PISTON
3. LEVER & CONNECTING ROD ASSY. - PUMP	57. PISTON - POWER VALVE
4. POPRIVET (3) - RETAINER	58. SPRING - POWER PISTON
5. CHOKE COVER & RETAINER ASSY.	59. SPRING - PUMP RETURN
6. GASKET - CHOKE COVER	60. SEAL - PUMP WEIGHT
7. SCREW - CHOKE SHAFT LEVER	61. WEIGHT - PUMP DISCHARGE SPRING
8. LEVER - CHOKE SHAFT	62. SPRING - PUMP DISC BALL
9. SCREW & LOCKWASHER (3) - CHOKE HOUSING	63. BALL - PUMP DISC. CHECK (LARGE)
10. HOUSING - CHOKE	64. RETAINER - INTAKE CHECK BALL
11. CHOKE PULL OFF & LINK ASSY.	65. BALL - INTAKE CHECK (SMALL)
12. WASHER - LEVER SPACER	66. PLUG - AUX. PUMP CHECK BALL SPRING
13. SPRING - SEC. RETURN	67. SPRING - AUX. CHECK BALL
14. RETAINER - SEC. DIAPHRAGM LINK	68. BALL - AUX. PUMP DISC. CHECK
15. SPRING - THROTTLE RETURN	69. PLUG - AUX. PUMP CHECK BALL
16. SCREW & LOCKWASHER (2) - SEC. DIAPHRAGM ASSY.	70. BALL - AUX. PUMP INTAKE CHECK
17. SECONDARY DIAPHRAGM ASSY.	71. JET - IDLE (SLOW)
18. GASKET - SEC. DIAPHRAGM ASSY.	72. SEAL - PRI. VENTURI
19. RETAINER CUP - SPRING	73. SCREW & LOCKWASHER (2) - PRI. VENTURI
20. SPRING - THROTTLE RETURN	74. PRIMARY VENTURI ASSY.
21. RETAINER - AUX. PULL OFF LINK	75. GASKET - PRI. VENTURI
22. RETAINER - T.P. LINK	76. SCREW & LOCKWASHER (2) - SEC. VENTURI
23. SCREW & LOCKWASHER (2) - BRACKET	77. SECONDARY VENTURI ASSY.
24. THROTTLE POSITIONER ASSY. AND AUX. PULL OFF ASSY.	78. GASKET - SEC. VENTURI
25. WASHER - THROTTLE POSITIONER ROD	79. SCREW - IDLE ADJUSTING (RPM)
26. SOLENOID ASSY. PRI. IDLE CUT OFF	80. SPRING - IDLE SCREW
27. GASKET - SOLENOID	81. WASHER - IDLE SCREW SPRING
28. O-RING - PRI. SOLENOID	82. SCREW & LOCKWASHER - THROTTLE BODY (HOLLOW)
29. SOLENOID ASSY. - SEC. IDLE CUT OFF	83. SCREW & LOCKWASHER (3) - THROTTLE BODY
30. GASKET - SOLENOID	84. FLOAT BOWL ASSY.
31. O-RING - SEC. SOLENOID	85. POWER VALVE - ASSY.
32. BOLT - FUEL INLET FITTING	86. SCREW & LOCKWASHER (3) - AUX. PUMP COVER
33. GASKET (2) - FUEL INLET FITTING	87. COVER - AUX. PUMP DIAPHRAGM
34. FITTING - FUEL INLET	88. GASKET - AUX. PUMP COVER
35. SCREW & LOCKWASHER - BRACKET	89. SPRING - AUX. PUMP DIAPHRAGM
36. BRACKET - FUEL FITTING	90. DIAPHRAGM - AUX. PUMP
37. SCREW & LOCKWASHER - BRACKET	91. SCREW (2) - RETAINER SIGHT GLASS
38. BRACKET - WIRE LOOM	92. RETAINER - SIGHT GLASS
39. SCREW & LOCKWASHER - BRACKET	93. SIGHT GLASS
40. BRACKET - WIRE LOOM	94. O-RING - SIGHT GLASS SEAL
41. SCREW & LOCKWASHER - GAURD	95. PLUG - SEC. MAIN JET
42. GAURD - CHOKE LINKAGE	96. GASKET - PLUG
43. SCREW & LOCKWASHER - BRACKET	97. JET - SEC. MAIN (CROME)
44. BRACKET - AUX. ROD GUIDE	98. GASKET - SEC. MAIN JET
45. RETAINER - FAST IDLE ROD (LOWER)	99. PLUG - PRI. MAIN JET
46. SCREW & LOCKWASHER (4) - BOWL COVER	100. GASKET - PLUG
47. BOWL COVER ASSEMBLY	101. JET - PRI. MAIN (BRASS)
48. PIN - FLOAT	102. GASKET - PRI. MAIN JET
49. FLOAT ASSEMBLY	103. GASKET - THROTTLE BODY
50. NEEDLE & SEAT ASSY.	104. PLUG - IDLE NEEDLE
51. SCREEN - FUEL FILTER	105. NEEDLE - IDLE MIXTURE
52. GASKET - BOWL COVER	106. SPRING - IDLE NEEDLE
53. PUMP PLUNGER ASSY.	107. THROTTLE BODY ASSY.
54. BOOT - PUMP	

CLEANING

CLEANING MUST BE DONE WITH CARBURETOR DISASSEMBLED. SOAK PARTS LONG ENOUGH TO SOFTEN AND REMOVE ALL FOREIGN MATERIAL. (CAUTION: DO NOT PROLONG SOAKING OF PARTS CONTAINING PLASTIC MATERIALS THAT ARE NOT REMOVABLE.) MAKE CERTAIN THE THROTTLE BORES ARE FREE OF ALL CARBON DEPOSITS. WASH OFF IN SUITABLE SOLVENT. BLOW OUT ALL PASSAGES IN CASTINGS WITH COMPRESSED AIR AND CHECK CAREFULLY TO INSURE THOROUGH CLEANING OF OBSCURE AREAS. DO NOT SOAK DIAPHRAGM ASSEMBLIES, FLOAT, SOLENOIDS OR PARTS CONTAINING RUBBER MATERIAL.

REASSEMBLY

REASSEMBLE IN REVERSE ORDER OF DISASSEMBLY. NOTE SPECIAL INSTRUCTIONS AND ADJUSTMENTS.

SPECIAL INSTRUCTIONS

IDLE ADJUSTING NEEDLE INSTALLATION. TURN NEEDLE IN UNTIL LIGHTLY SEATED. THEN BACK OUT 2 1/2 - 3 TURNS. FINAL ADJUSTMENT SEE CAR SERVICE MANUAL.

THROTTLE BODY SCREW & LOCKWASHER (HOLLOW) (82) - BE SURE TO INSTALL IN PROPER HOLE (VACUUM PASSAGE FOR POWER VALVE PISTON).

PUMP PLUNGER (53) - REMOVE PAPER SLEEVE FROM LEATHER CUP. FLEX LEATHER OUTWARD SLIGHTLY, SOAK CUP IN LIGHT OIL A FEW MINUTES PRIOR TO PLACING IN CARBURETOR.

BOWL COVER GASKET & FUEL INLET NEEDLE PULL CLIP. DO NOT INSTALL UNTIL FLOAT LEVEL & DROP HAVE BEEN SET.

WHEN INSTALLING CHOKE COVER BE SURE HOOK ON COIL SPRING IS AGAINST ARM OF CHOKE SHAFT. ALIGN NOTCH IN COVER WITH RAISED BOSS IN CASTING. (THIS TYPE OF CHOKE COVER IS NON ADJUSTABLE.) INSTALL NEW POP RIVETS.

ADJUSTMENTS

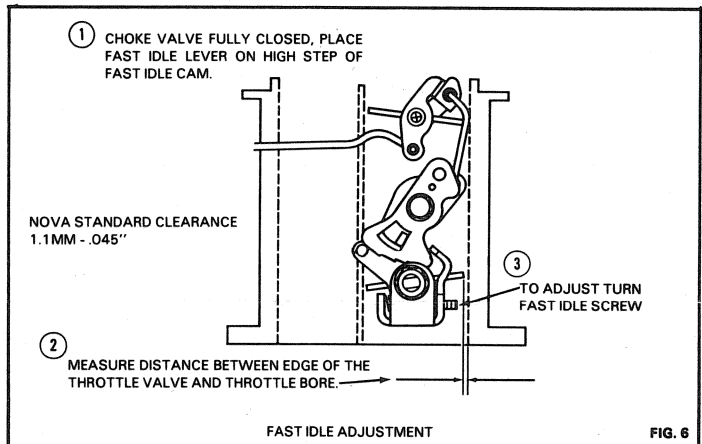
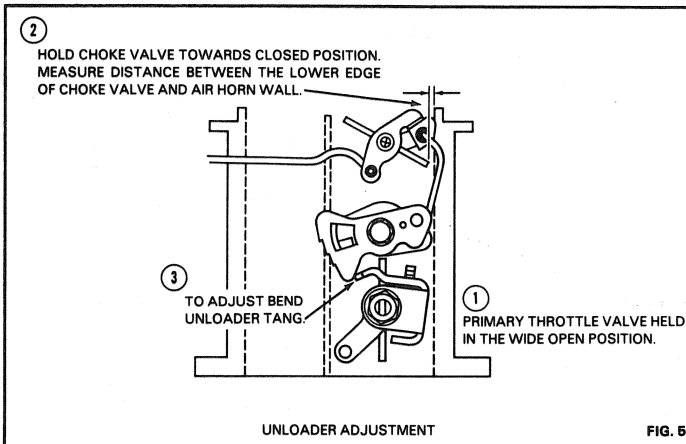
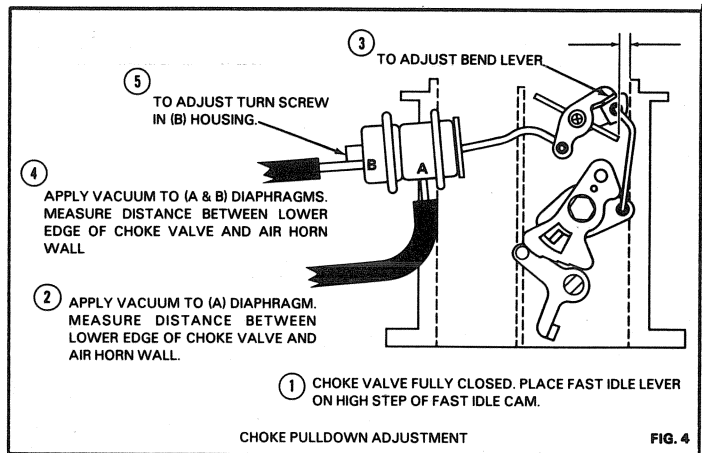
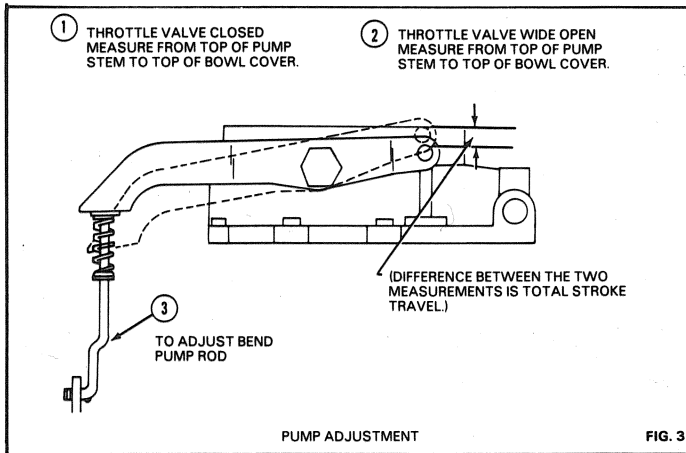
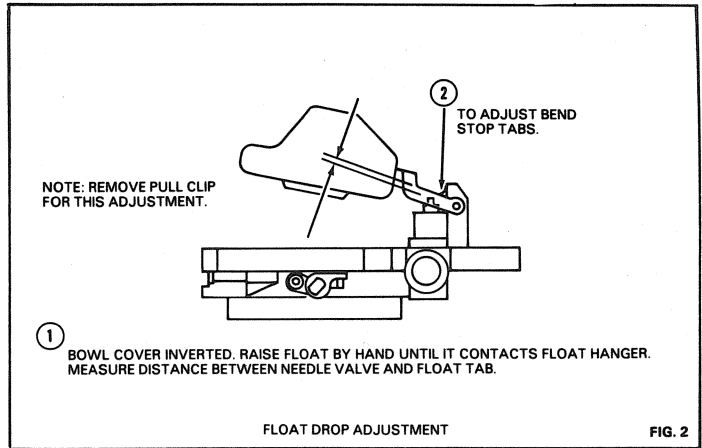
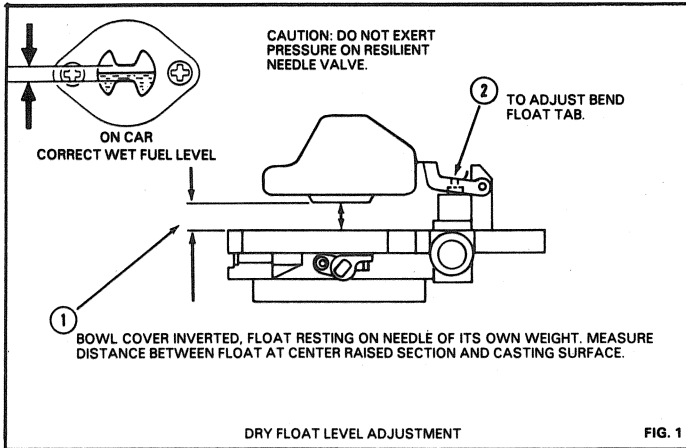

ADJUSTMENT DATA TABLE					
APPLICATION	FLOAT LEVEL	FLOAT DROP	PUMP STROKE	CHOKE PULLDOWN	UNLOADER
1984-85 COROLLA 4A-C ENG. U.S.A.	7.2MM-9/32"	1.8MM-.070"	4.0MM-.157"	A-38° B-55°	41°
1984-85 COROLLA 4A-C ENG. CAN.	7.2MM-9/32"	1.8MM-.070"	3.0MM-.118"	A-39° B-50°	47°
1986 COROLLA 4A-C ENG. U.S.A.	7.2MM-9/32"	1.8MM-.070"	2.0MM-.079"	A-38° B-50°	41°
1986 COROLLA 4A-C ENG. CAN.	7.2MM-9/32"	1.8MM-.070"	3.0MM-.118"	A-39° B-50°	47°
1985 NOVA 1.6L ENG.	7.2MM-9/32"	1.8MM-.070"	4.0MM-.157"	A-.095"-2.4MM B-.254"-6.2MM	.120"-3MM
1986 NOVA 1.6L ENG.	7.2MM-9/32"	1.8MM-.070"	2.0MM-.079"	A-.095"-2.4MM B-.254"-6.2MM	.120"-3MM
1987 NOVA 1.6L ENG.	7.0MM-9/32"	1.8MM-.070"	2.0MM-.079"	A-.095"-2.4MM B-.254"-6.2MM	.120"-3MM

WHEN DEGREE SETTINGS OR GIVEN, A SPECIAL PROTRACTOR GAUGE IS NEEDED TO MEASURE ANGLE OF CHOKE VALVE.