

## OFF VEHICLE CARBURETOR SERVICE HOLLEY MODEL 2380 EG

GENERAL EXPLODED VIEW  
ACTUAL UNITS MAY VARY

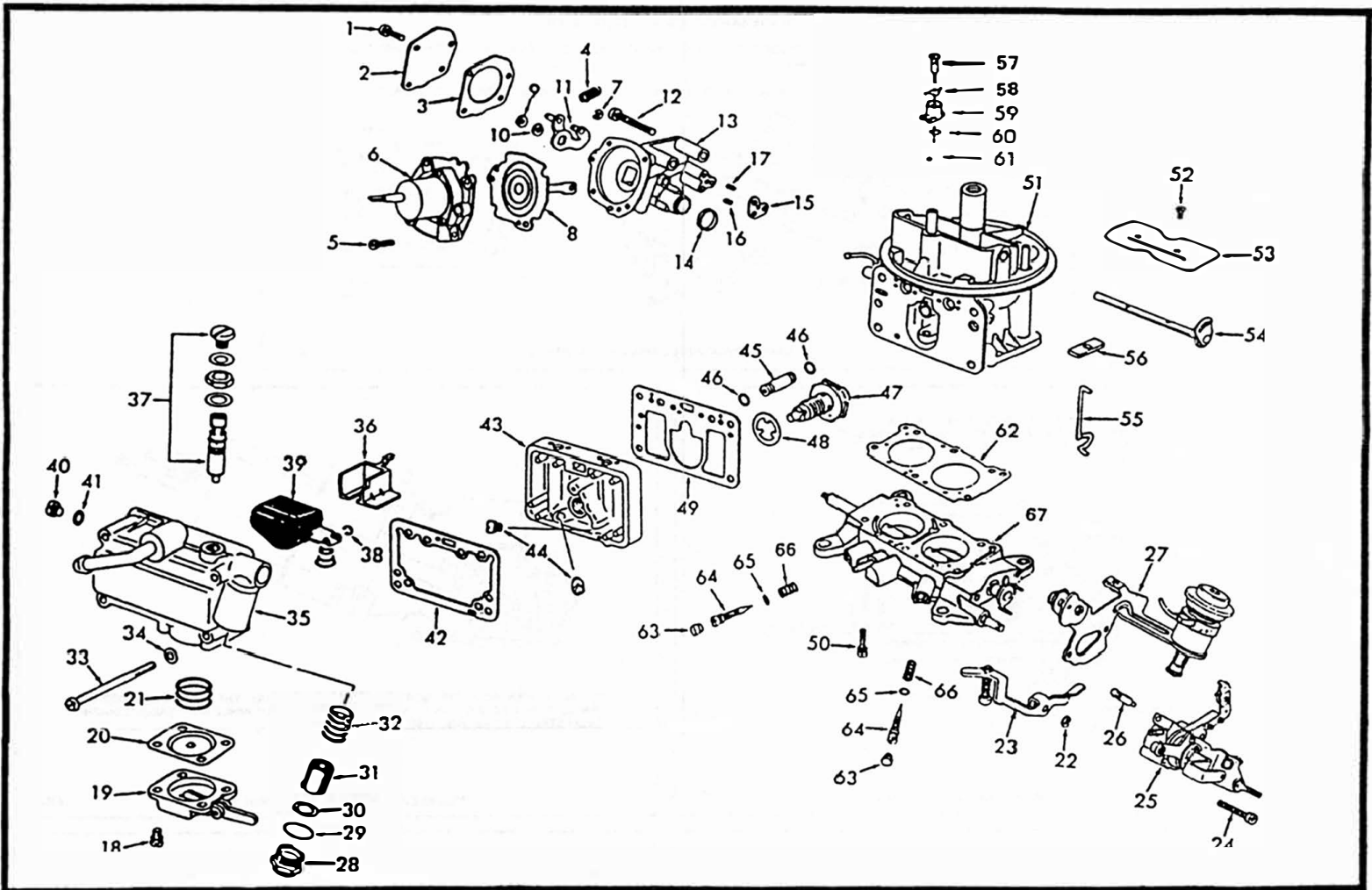

### DISASSEMBLY

USE EXPLODED VIEW AS A GUIDE. THE NUMERICAL SEQUENCE MAY GENERALLY BE FOLLOWED TO DISASSEMBLE UNIT FAR ENOUGH FOR CLEANING AND INSPECTION. NOTE: THE CHOKE PLATE RETAINING SCREWS ARE STAKED AT THE THREADED END. THIS STAKING MUST BE FILED OFF BEFORE REMOVING THE SCREWS (BE CAREFUL NOT TO OAMAGE THE CHOKE SHAFT OR VENTURI WHILE FILING). TO REMOVE TAMPERPROOF IDLE MIXTURE SCREWS SEE FIG. 1.

### CLEANING

CLEANING MUST BE DONE WITH CARBURETOR DISASSEMBLED. SOAK PARTS LONG ENOUGH TO SOFTEN AND REMOVE ALL FOREIGN MATERIAL USING A COLD IMMERSION TYPE CARBURETOR CLEANER. MAKE CERTAIN THE THROTTLE BORES ARE FREE OF ALL CARBON AND VARNISH DEPOSITS. RINSE OFF IN SUITABLE SOLVENT. BLOW OUT ALL PASSAGES IN CASTINGS WITH COMPRESSED AIR AND CHECK CAREFULLY TO INSURE THOROUGH CLEANING OF OBSCURE AREAS. CAUTION: DO NOT SOAK PARTS CONTAINING RUBBER, FLOATS, OR DIAPHRAGM ASSEMBLIES.

### REASSEMBLY

REASSEMBLE IN REVERSE ORDER OF DISASSEMBLY. NOTE SPECIAL INSTRUCTIONS AND FOLLOW NUMERICAL OUTLINE IN MAKING ADJUSTMENTS NECESSARY FOR CARBURETOR BEING SERVICED.

### SPECIAL INSTRUCTIONS

THROTTLE BODY SCREWS (50): CROSS-TIGHTEN IN THREE STAGES TO ARRIVE AT CORRECT TORQUE (50 INCH-POUNDS).  
IDLE ADJUSTING SCREWS (64): TURN IN UNTIL LIGHTLY SEATED, THEN BACK OUT NUMBER OF TURNS RECORDED ON DISASSEMBLY.  
ENRICHMENT VALVE (47): TORQUE TO 100 INCH-POUNDS.  
O-RINGS-LIGHTLY LUBRICATE FOR EASIER INSTALLATION.  
FUEL BOWL (36): BEFORE INSTALLING MAKE DRY FLOAT ADJUSTMENT.  
BOWL SCREWS AND GASKETS (33), (34): INSTALL GASKETS ON SCREWS, TORQUE EVENLY IN STAGES TO 60 INCH-POUNDS.

### NOMENCLATURE

REF. NO.	REF. NO.
1. SCREW & WASHER (4), COVER	33. SCREW (4), FUEL BOWL
2. COVER, GOVERNOR HOUSING	34. GASKET (4), FUEL BOWL SCREW
3. GASKET, COVER	35. FUEL BOWL ASSEMBLY
4. SPRING, GOVERNOR	36. BAFFLE PLATE
5. SCREW & WASHER (4), DIAPHRAGM COVER & SOLENOID ASSEMBLY	37. NEEDLE & SEAT ASSEMBLY
6. COVER ASSY., DIAPH. & SOLENOID	38. E-CLIP, FLOAT RETAINER
7. E-CLIP, DIAPHRAGM STEM RETAINER	39. FLOAT & SPRING ASSEMBLY
8. DIAPHRAGM ASSEMBLY	40. PLUG, FUEL LEVEL
9. NUT, GOVERNOR LEVER	41. GASKET, PLUG
10. LOCKWASHER, GOVERNOR LEVER	42. GASKET, FUEL BOWL
11. GOVERNOR LEVER	43. METERING BLOCK ASSEMBLY
12. SCREW & WASHER (3), GOV. HSNG.	44. JETS (2), MAIN
13. HOUSING ASSEMBLY, GOVERNOR	45. CONNECTOR, PUMP CHANNEL
14. SEAL, GOVERNOR HOUSING	46. O-RING (2), CONNECTOR
15. GASKET, GOVERNOR HOUSING	47. VALVE, ENRICHMENT (2-STAGE)
16. JET A, GOVERNOR HOUSING	48. GASKET, ENRICHMENT VALVE
17. JET B, GOVERNOR HOUSING	49. GASKET, METERING BLOCK
18. SCREW & WASHER (4), COVER	50. SCREW & WASHER (6), THROTT. BODY
19. COVER ASSEMBLY, PUMP DIAPHRAGM	51. MAIN BODY ASSEMBLY
20. PUMP DIAPHRAGM	52. SCREW (2), CHOKE PLATE
21. SPRING, DIAPHRAGM	53. PLATE, CHOKE
22. E-CLIP, LEVER	54. SHAFT, CHOKE PLATE
23. LEVER ASSEMBLY, PUMP	55. ROD, CHOKE
24. SCREW (2), THROTTLE OPERATING SHAFT HOUSING	56. SEAL, CHOKE ROD
25. HOUSING ASSY., THROTTLE OPERATING SHAFT	57. SCREW, PUMP DISCHARGE NOZZLE
26. PLUNGER & SCREW, FAST IDLE	58. LOCKPLATE, PUMP DISCH. NOZZLE
27. BRACKET ASSY., CHOKE LEVER AND DASHPOT	59. NOZZLE, PUMP DISCHARGE
28. FITTING, FUEL INLET	60. GASKET, PUMP DISCH. NOZZLE
29. GASKET, FUEL FITTING	61. BALL, PUMP DISCHARGE
30. GASKET, FUEL FILTER	62. GASKET, THROTTLE BODY
31. FUEL FILTER	63. PLUG (2), IDLE LIMITER
32. SPRING, FUEL FILTER	64. SCREW (2), IDLE ADJUSTING
	65. O-RING (2), IDLE ADJ. SCREW
	66. SPRING (2), IDLE ADJ. SCREW
	67. THROTTLE BODY ASSEMBLY

# ADJUSTMENTS

TO REMOVE TAMPERPROOF IDLE MIXTURE SCREW PLUGS, INVERT THE CARBURETOR AND CENTER PUNCH THE THROTTLE BODY 5/16 INCH FROM THE FACE OF EACH SCREW CAVITY AS SHOWN. USING A 1/8 INCH DRILL BIT, DRILL APPROXIMATELY 1/16 INCH DEEP. THEN TIP THE DRILL BACK SUCH THAT THE BIT IS POINTED TOWARD THE PLUG (TIP APPROXIMATELY 80° WITH RESPECT TO THE THROTTLE BODY FACE). DRILL THROUGH UNTIL THE BIT CONTACTS THE TAMPERPROOF PLUG.

WITH A 1/8 INCH OR LESS DIAMETER PUNCH GENTLY TAP OUT THE TAMPERPROOF PLUGS.

BEFORE REMOVING IDLE ADJUSTING SCREWS, CAREFULLY TURN SCREWS IN CLOCKWISE COUNTING THE NUMBER OF TURNS IT TAKES TO LIGHTLY SEAT SCREWS. (RECORD FOR PROPER REASSEMBLY). IDENTIFY SCREWS TO RETURN TO THE SAME HOLES. (RIGHT AND LEFT).

REASSEMBLY TURN IN IDLE MIXTURE SCREWS UNTIL LIGHTLY SEATED. THEN BACK OUT THE NUMBER OF TURNS RECORDED ON DISASSEMBLY.

REPLACE PLUG AFTER IDLE MIXTURE SETTING PROCEDURE. (ENGINE/EMISSIONS DIAGNOSIS MANUAL)

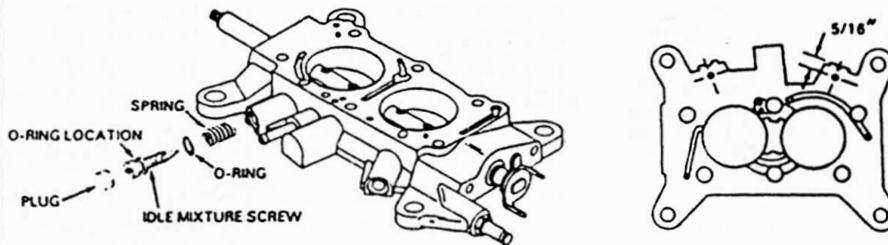

TAMPERPROOF IDLE MIXTURE SCREWS

FIG. 1

FLOAT BOWL INVERTED, TURN NEEDLE SEAT ASSY UNTIL FLOAT SURFACE IS PARALLEL WITH THE SURFACE DIRECTLY BELOW THE FLOAT. TIGHTEN LOCK SCREW

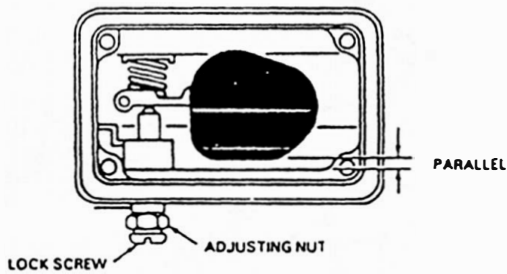

DRY FLOAT LEVEL ADJUSTMENT

FIG. 2

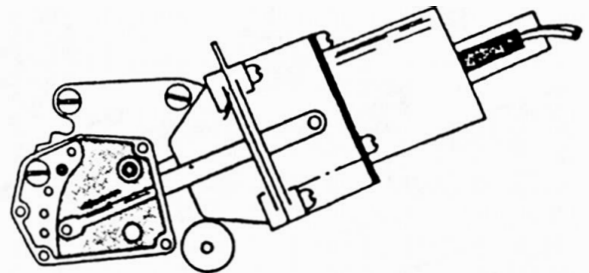

INSTALL COVER WITH THE SCREWS FINGER TIGHT PULL THE DIAPHRAGM ROD AS FAR AS IT WILL GO AND THEN TIGHTEN SCREWS EVENLY WHILE MAINTAINING DIAPHRAGM STRETCHED IN THIS POSITION.

INSTALLING GOVERNOR DIAPHRAGM

FIG. 2

ADJUSTMENT SCREW

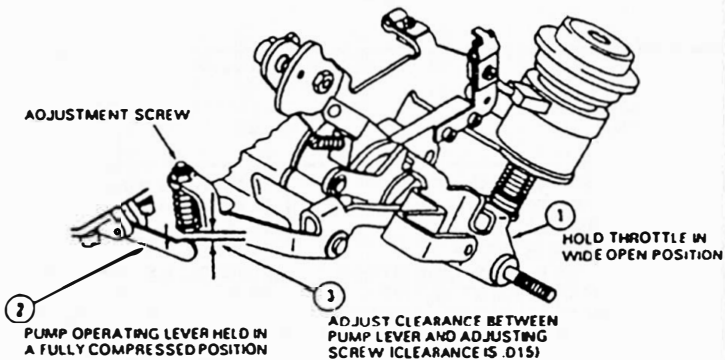

PUMP ADJUSTMENT

FIG. 4

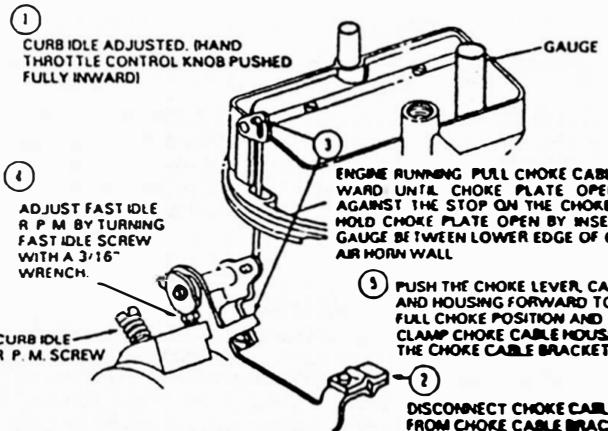

FAST IDLE SPEED ADJUSTMENT

FIG. 5