

INSTRUCTION SHEET

OFF VEHICLE CARBURETOR SERVICE

AISAN 2 BARREL

50-671-2

GENERAL EXPLODED VIEW

THE GENERAL DESIGN AND PARTS SHOWN WILL VARY TO
INDIVIDUAL UNITS COVERED ON THIS INSTRUCTION SHEET.

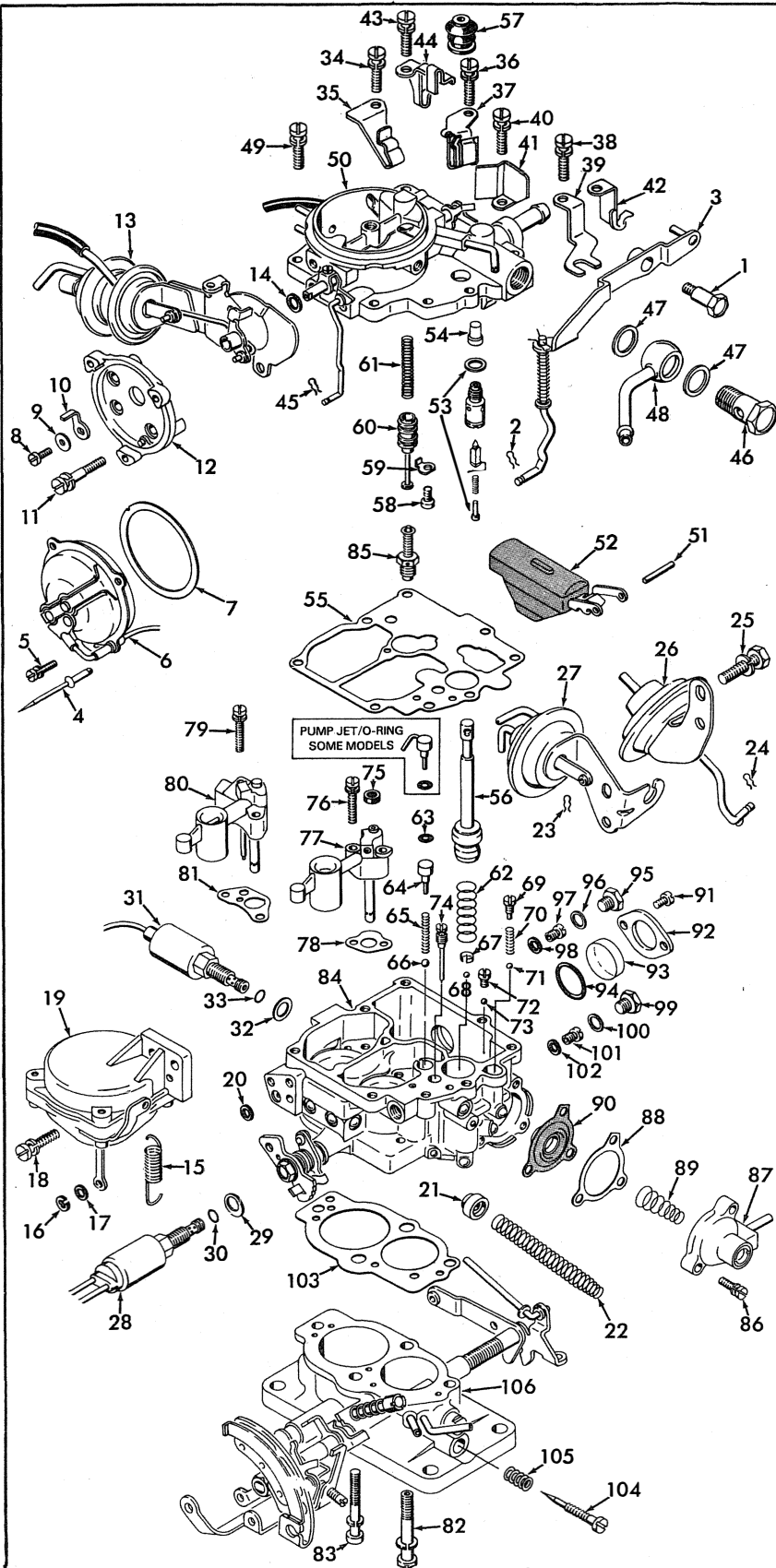

DISASSEMBLY

USE EXPLODED VIEW AS A GUIDE. THE NUMERICAL SEQUENCE MAY GENERALLY BE FOLLOWED TO DISASSEMBLE UNIT FAR ENOUGH TO PERMIT CLEANING AND INSPECTION. NOTE: TO REMOVE TAMPER RESISTANT RETAINER FROM CHOKE COVER, CAREFULLY DRILL RIVET HEADS OFF. REMOVE CHOKE COMPONENTS THEN KNOCK OUT REMAINDER OF RIVETS. DISASSEMBLY OF SECONDARY VACUUM UNIT (19) IS NOT NECESSARY UNLESS DIAPHRAGM IS BEING REPLACED. TO REMOVE IDLE MIXTURE NEEDLE PLUG, CENTER PUNCH CENTER OF PLUG, CAREFULLY DRILL A .25" HOLE IN PLUG. (NOTE THERE IS ONLY .040" CLEARANCE BETWEEN PLUG AND MIXTURE SCREW.) PRY REMAINDER OF PLUG FROM HOLE.

NOMENCLATURE

REF. NO.	REF. NO.
1. SCREW-PUMP LEVER	52. FLOAT ASSEMBLY
2. RETAINER-PUMP ROD	53. NEEDLE & SEAT ASSEMBLY
3. LEVER & CONNECTING ROD ASSY.-PUMP	54. SCREEN-FUEL FILTER
4. POP RIVET (4) SOME MODELS-RETAINER	55. GASKET-BOWL COVER
5. SCREW & LKWSHR. (3) SOME MODELS-RETAINER	56. PUMP PLUNGER ASSEMBLY
6. CHOKE COVER & RETAINER ASSY.	57. BOOT-PUMP
7. GASKET-CHOKE COVER	58. SCREW & LKWSHR.-PISTON RETAINER
8. SCREW -CHOKE SHAFT ARM	59. RETAINER-PISTON
9. WASHER-SCREW	60. PISTON-POWER VALVE
10. LEVER-CHOKE SHAFT	61. SPRING-POWER PISTON
11. SCREW & LKWSHR. (3)-CHOKE HOUSING	62. SPRING-PUMP RETURN
12. HOUSING-CHOKE	63. SEAL-PUMPWEIGHT
13. CHOKE PULL OFF & LINK ASSY.	64. WEIGHT-PUMP DISCHARGESPRING
14. WASHER-LEVER SPACER	65. SPRING-PUMP DISC. BALL
15. SPRING-SEC. RETURN	66. BALL-PUMP DISC. CHECK (LARGE)
16. RETAINER-SEC. DIA. LINK	67. RETAINER-INTAKE CHECK BALL
17. WASHER-SEC. DIA. LINK	68. BALL-INTAKE CHECK (SMALL)
18. SCREW & LKWSHR. (2)-SEC. DIAPHRAGM	69. PLUG-AUX. PUMP CHECK BALL SPRING
19. SECONDARY DIAPHRAGM ASSY.	70. SPRING-AUX. CHECK BALL
20. GASKET-SEC. DIAPHRAGM ASSY.	71. BALL-AUX. PUMP DISC. CHECK
21. CUP RETAINER-SPRING	72. PLUG-AUX. PUMP CHECK BALL
22. SPRING-THROTTLE RETURN	73. BALL-AUX. PUMP INTAKE CHECK
23. RETAINER-AUX. PULL OFF LINK	74. JET-IDLE
24. RETAINER-T. P. LINK	75. SEAT-PRI. VENTURI
25. SCREW & LKWSHR. (2)-BRACKET	76. SCREW & LKWSHR. (2)-PRI. VENTURI
26. THROTTLE POSITIONER ASSY.	77. PRIMARY VENTURI ASSY.
27. AUX. PULL OFF ASSEMBLY	78. GASKET-PRI. VENTURI
28. SOLENOID ASSY.-PRI. IDLE CUT OFF	79. SCREW & LKWSHR. (2)-SEC. VENTURI
29. GASKET-SOLENOID	80. SECONDARY VENTURI ASSY.
30. O-RING-PRI. SOLENOID	81. GASKET-SEC. VENTURI
31. SOLENOID ASSY.-SEC. IDLE CUT OFF	82. SCREW & LKWSHR. (HOLLOW)-THROTTLE BODY
32. GASKET-SOLENOID	83. SCREW & LKWSHR. (3)-THROTTLE BODY
33. O-RING-SEC. SOLENOID	84. FLOAT BOWL ASSEMBLY
34. SCREW & LKWSHR.-BRACKET	85. POWER VALVE ASSEMBLY
35. BRACKET-WIRE LOOM	86. SCREW & LKWSHR. (3)-AUX. PUMP COVER
36. SCREW & LKWSHR.-BRACKET	87. COVER-AUX. PUMP DIAPHRAGM
37. BRACKET-WIRE LOOM	88. GASKET-AUX. PUMP COVER
38. SCREW & LKWSHR.-BRACKET	89. SPRING-AUX. PUMP DIAPHRAGM
39. BRACKET-FUEL PIPE	90. DIAPHRAGM-AUX. PUMP
40. SCREW & LKWSHR.-BRACKET & GAURD	91. SCREW (2)-RETAINER SIGHT GLASS
41. GAURD-CHOKE LINKAGE	92. RETAINER-SIGHT GLASS
42. BRACKET-WIRE LOOM	93. SIGHT GLASS
43. SCREW & LKWSHR.-BRACKET	94. O-RING-SIGHT GLASS SEAL
44. BRACKET-AUX. ROD GUIDE	95. PLUG-SEC. MAIN JET
45. RETAINER-FAST IDLE ROD (LOWER)	96. GASKET-PLUG
46. BOLT-FUEL INLET FITTING	97. JET-SEC. MAIN (CROMIE)
47. GASKET (2)-FUEL INLET FITTING	98. GASKET-SEC. MAIN JET
48. FITTING-FUEL INLET	99. PLUG-PRI. MAIN JET
49. SCREW & LKWSHR. (3)-BOWL COVER	100. GASKET-PLUG
50. BOWL COVER ASSEMBLY	101. JET-PRI. MAIN (BRASS)
51. PIN-FLOAT	102. GASKET-PRI. MAIN JET
	103. GASKET-THROTTLE BODY
	104. NEEDLE-IDLE ADJUSTING
	105. SPRING-IDLE ADJ. NEEDLE
	106. THROTTLE BODY ASSEMBLY

CLEANING

CLEANING MUST BE DONE WITH CARBURETOR DISASSEMBLED. SOAK PARTS LONG ENOUGH TO SOFTEN AND REMOVE ALL FOREIGN MATERIAL. (CAUTION: DO NOT PROLONG SOAKING OF PARTS CONTAINING PLASTIC MATERIALS THAT ARE NOT REMOVABLE.) MAKE CERTAIN THE THROTTLE BORES ARE FREE OF ALL CARBON DEPOSITS. WASH OFF IN SUITABLE SOLVENT. BLOW OUT ALL PASSAGES IN CASTINGS WITH COMPRESSED AIR AND CHECK CAREFULLY TO INSURE THOROUGH CLEANING OF OBSCURE AREAS. DO NOT SOAK DIAPHRAGM ASSEMBLIES, FLOAT, SOLENOIDS OR PARTS CONTAINING RUBBER MATERIAL.

REASSEMBLY

REASSEMBLE IN REVERSE ORDER OF DISASSEMBLY. NOTE SPECIAL INSTRUCTIONS AND ADJUSTMENTS.

SPECIAL INSTRUCTIONS

IDLE ADJUSTING NEEDLE INSTALLATION. TURN NEEDLE IN UNTIL LIGHTLY SEATED, THEN BACK OUT 2 1/2-3 TURNS. FINAL ADJUSTMENT SEE CAR SERVICE MANUAL.

THROTTLE BODY SCREW & LOCK WASHER (HOLLOW) (82)-BE SURE TO INSTALL IN PROPER HOLE. (VACUUM PASSAGE FOR POWER VALVE PISTON.)

PUMP PLUNGER (56)-REMOVE PAPER SLEEVE FROM LEATHER CUP. FLEX LEATHER OUTWARD SLIGHTLY; SOAK CUP IN LIGHT OIL A FEW MINUTES PRIOR TO PLACING IN CARBURETOR.

BOWL COVER GASKET & FUEL INLET NEEDLE PULL CLIP. DO NOT INSTALL UNTIL FLOAT LEVEL & DROP HAVE BEEN SET.

WHEN INSTALLING CHOKE COVER BE SURE HOOK ON COIL SPRING IS AGAINST ARM OF CHOKE SHAFT. ALIGN NOTCH IN COVER WITH RAISED BOSS IN CASTING. (THIS TYPE OF CHOKE COVER IS NON ADJUSTABLE.) INSTALL NEW POP RIVETS.

CHOKE COVERS WITHOUT NOTCH, ALIGN MARK ON CHOKE COVER WITH INDEX MARK ON CHOKE HOUSING.

ADJUSTMENTS

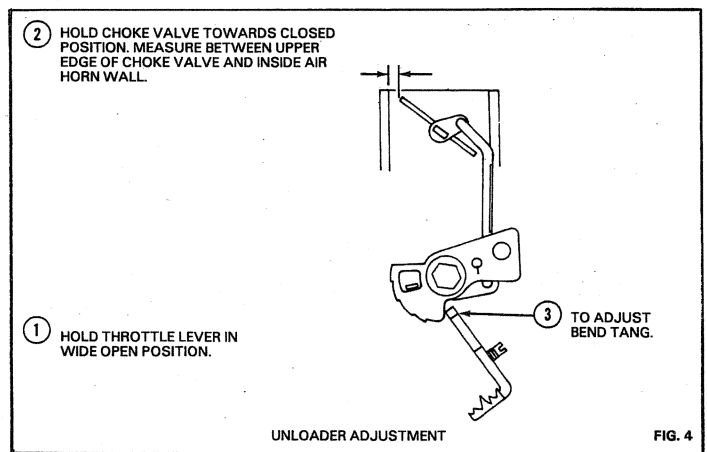
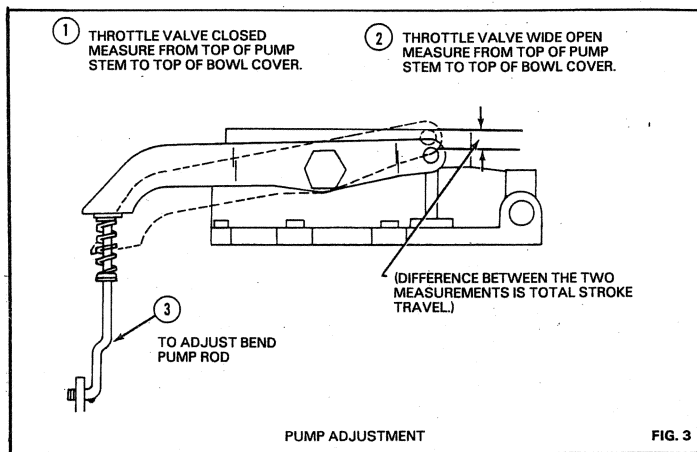
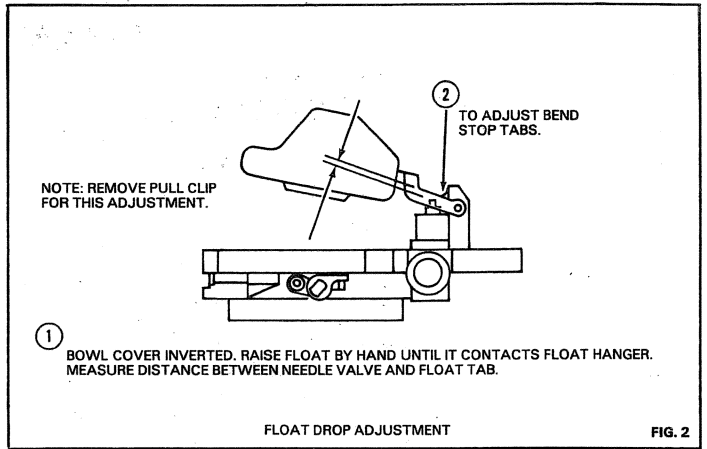
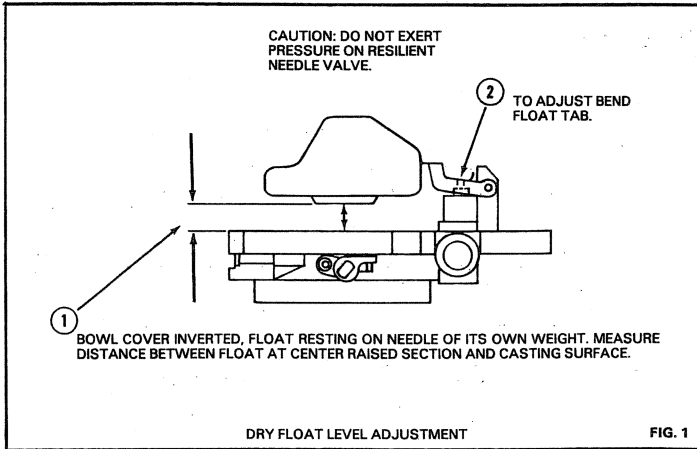

ADJUSTMENT DATA TABLE

APPLICATION	DRY FLOAT LEVEL	FLOAT DROP	PUMP ADJ.	UNLOADER
1981-82 COROLLA 3T-C ENG.	9.2MM/3/8"	1.6MM/.063"	5.0MM/.197"	3.5MM/9/64"
1983-85 COROLLA 4A-C ENG. U.S.A.	7.2MM/9/32"	1.8MM/.070"	4.0MM/.157"	3.5MM/9/64"
1983-85 COROLLA 4A-C ENG. CAN.	7.2MM/9/32"	1.8MM/.070"	3.0MM/.118"	3.5MM/9/64"
1981 TERCEL 3A-C ENG.	4.0MM/5/32"	1.2MM/.047"	3.0MM/.118"	3.5MM/9/64"
1982 TERCEL 3A-C ENG.	7.2MM/9/32"	1.8MM/.070"	3.0MM/.118"	3.5MM/9/64"
1983-88 TERCEL 3A-C ENG. U.S.A.	7.2MM/9/32"	1.8MM/.070"	4.0MM/.157"	3.5MM/9/64"
1983-88 TERCEL 3A-C ENG. CAN.	7.2MM/9/32"	1.8MM/.070"	3.0MM/.118"	3.5MM/9/64"