

INSTRUCTION SHEET

OFF VEHICLE CARBURETOR SERVICE (MIKUNI) SOLEX-MODEL 32-35 DIDTA

50-605-1

GENERAL EXPLODED VIEW
THE GENERAL DESIGN AND PARTS SHOWN WILL VARY TO
INDIVIDUAL UNITS COVERED ON THIS INSTRUCTION SHEET

DISASSEMBLY

USE EXPLODED VIEW AS A GUIDE. THE NUMERICAL SEQUENCE MAY GENERALLY BE FOLLOWED TO DISASSEMBLE UNIT FAR ENOUGH TO PERMIT CLEANING AND INSPECTION. (CAUTION: NOT ALL DIAPHRAGMS ARE REPAIR KIT REPLACEMENT PARTS. HANDLE CAREFULLY. THEY WILL BE USED OVER) TO REMOVE TAMPER RESISTANT CHOKE COVER, GRIND OR FILE OFF THE 2 ROLLED OVER SCREW HEADS. SAW A SCREWDRIVER SLOT IN THE 3 BREAKAWAY SCREW HEADS. REMOVE SCREWS & COVER. SCREEN & SHIM FROM NEEDLE SEAT WILL BE USED OVER. RECORD SIZES OF ALL JETS & THEIR LOCATION. TO REMOVE UPPER WATER PIPE & CHOKE BREAKER DIAPHRAGM REMOVE UPPER GEAR BRACKET SCREW TO WASHERS (82). (DO NOT REMOVE LOWER SCREW). RAISE BRACKET JUST FAR ENOUGH TO GAIN ACCESS TO WATER PIPE SCREWS. (DO NOT DISENGAGE PLASTIC GRILL) REMOVE CHOKE BREAKER PARTS. TO REMOVE IDLE ADJUSTING NEEDLE PLUG, DRILL SMALL HOLE IN PLUG, THEN PULL OUT WITH AN EASY OUT. USING A PIN PUNCH DRIVE ROLL PIN OUT. BEFORE REMOVING IDLE ADJUSTING NEEDLE (115), TURN IN COUNTING THE NUMBER OF TURNS IT TAKES TO LIGHTLY SEAT NEEDLE AND RECORD FOR REASSEMBLY.

NOMENCLATURE

REF. NO.	REF. NO.
1. WATER HOSE & CLAMP	57. NEEDLE & SEAT ASSY. W/SCREEN
2. SCREW (3) - COVER	58. SHIM - NEEDLE SEAT (USE OVER)
3. COVER - TAMPER RESISTANT	59. SCREW & LOCKWASHER (2) - PRIMARY PEDESTAL
4. E-CLIP - THROTTLE OPENER LINK	60. PRIMARY MAIN JET & PEDESTAL ASSY.
5. SCREW & LOCKWASHER (2) - THROTTLE OPENER BRACKET	61. GASKET - PRI. PEDESTAL
8. THROTTLE OPENER & BRACKET ASSY.	62. SCREW & LOCKWASHER (2) - SECONDARY PEDESTAL
7. SCREW & LOCKWASHER (2) - SECONDARY VACUUM ASSY.	63. SECONDARY MAIN JET & PEDESTAL ASSY.
9. SCREW & LOCKWASHER - GRD. LEAD	64. GASKET - SEC. PEDESTAL
10. SCREW & LOCKWASHER - FUEL CUT OFF SOLENOID	65. VENTURI - PRIMARY
11. SOLENOID ASSY. - FUEL CUT OFF	66. O-RING - VENTURI
12. O-RING - FUEL CUT OFF SOLENOID	67. RETAINER - VENTURI
13. SCREW & LOCKWASHER - GRD. LEAD & WIRE BRACKET	68. VENTURI - SECONDARY
14. SCREW & LOCKWASHER (3) - BOWL VENT SOLENOID	69. O-RING - VENTURI
15. SOLENOID ASSY. - BOWL VENT	70. RETAINER - VENTURI
16. SPRING - BOWL VENT SOLENOID	71. SCREW & WASHERS - LOCK
17. SCREW & LOCKWASHER - BOWL VENT HOUSING	72. LOCK - PRIMARY PILOT JET
18. BOWL VENT HOUSING ASSY.	73. JET - PRIMARY PILOT
19. SEAL - VENT VALVE HOUSING	74. O-RING - INNER (PRI. JET)
20. O-RING - VENT VALVE HOUSING	75. O-RING - OUTER (PRI. JET)
21. E-CLIP - VENT VALVE	76. SCREW & WASHERS - LOCK
22. VENT VALVE	77. LOCK - SECONDARY PILOT JET
23. DIAPHRAGM - VENT VALVE	78. JET - SECONDARY PILOT
24. SCREW & LOCKWASHER (3) - COASTING AIR VALVE COVER - C.A.V.	79. O-RING - SEC. PILOT JET
25. SLEEVE - C.A.V. SPRING	80. JET - PRIMARY AIR BLEED
26. SPRING - C.A.V.	81. JET - SECONDARY AIR BLEED
27. RETAINER - C.A.V. SPRING	82. SCREW & WASHERS - BRACKET UPPER
28. DIAPHRAGM - C.A.V.	83. SCREW & LOCKWASHERS (2) - WATERPIPE
29. SCREW & LOCKWASHER (2) - ENRICHMENT VALVE	84. PIPE - WATER
31. COVER - ENRICHMENT VALVE	85. GASKET - WATER PIPE
32. SPRING - DIAPHRAGM RETURN	86. SCREW & LOCKWASHER (3) - COVER
33. NUT - VALVE STEM	87. COVER - CHOKE BREAKER
34. WASHER (2) - DIAPHRAGM	88. SPRING - CHOKE BREAKER DIAPHRAGM
35. DIAPHRAGM - ENRICHMENT VALVE	89. DIAPHRAGM ASSY. - CHOKE BREAKER
36. WASHER - STEM (FIBER)	90. GASKET - BOWL COVER
37. HOUSING - ENRICHMENT VALVE	91. BOWL ASSY. - FUEL
38. VALVE (RUBBER) - ENRICHMENT	92. NUT - BOWL CAVITY
39. STEM - ENRICHMENT VALVE	93. WEIGHT - PUMP CHECK BALL
40. GASKET - VALVE MOUNTING	94. BALL - PUMP CHECK
41. JET - ENRICHMENT	95. SCREW & NUT (4) - PUMP COVER
42. SCREW & LOCKWASHER (2) - AIR SWITCHING VALVE COVER - A.S.V.	96. COVER, LEVER, & LINK ASSY. - PUMP
43. SLEEVE - A.S.V. SPRING	97. DIAPHRAGM ASSY. - PUMP
44. SPRING - A.S.V.	98. SPRING - DIAPHRAGM
45. RETAINER - A.S.V. SPRING	99. HOUSING - INLET CHECK BALL
46. DIAPHRAGM - A.S.V.	100. GASKET - HOUSING
47. SCREW & LOCKWASHER (2) - VACUUM HOSE CONNECTOR	101. GASKET - THROTTLE BODY
48. VACUUM HOSES & CONNECTOR ASSY.	102. E-CLIP PIN
49. SCREW LOCKWASHER & NUT (3) - BOWL COVER	103. PIN - SUB. EGR VALVE
50. SCREW & LOCKWASHER (2) - BOWL COVER (CENTER)	104. BOOT - EGR VALVE
51. SCREW & LOCKWASHER (2) - BOWL COVER (CENTER)	105. VALVE - EGR
52. BOWL COVER ASSY.	106. BALL - EGR VALVE
53. PIN - FLOAT	107. SPRING - BALL
54. FLOAT & LEVER ASSY.	108. SCREW & LOCKWASHER (3) - COVER
55. SCREW & LOCKWASHER - NEEDLE SEAT RETAINER	109. COVER - JET AIR CONTROL VALVE
56. RETAINER - NEEDLE SEAT	110. SPRING - J.A.C.V.
	111. RETAINER - SPRING
	112. DIAPHRAGM - J.A.C.V.
	113. PLUG - IDLE NEEDLE CONCEALMENT
	114. PIN - IDLE NEEDLE
	115. NEEDLE - IDLE ADJUSTING
	116. O-RING - IDLE ADJ. NEEDLE
	117. SPRING - IDLE ADJ. NEEDLE
	118. THROTTLE BODY ASSY.

CLEANING

CLEANING MUST BE DONE WITH CARBURETOR DISASSEMBLED. (DO NOT SOAK IN CARB. CLEANER) CLEAN ALL THE PASSAGES & BODIES OF THE CARBURETOR WITH SPRAY CARBURETOR CLEANER. MAKE CERTAIN THE THROTTLE BODY IS FREE OF ALL CARBON DEPOSITS. WASH OFF IN SUITABLE SOLVENT. BLOW OUT ALL PASSAGES AND JETS IN CASTINGS WITH COMPRESSED AIR AND CHECK CAREFULLY TO INSURE THOROUGH CLEANING OF OBSCURE AREAS. CAUTION: DO NOT USE CLEANING FLUIDS ON SOLENOIDS, DIAPHRAGMS, RUBBER PARTS, FLOAT OR SWITCHES.

REASSEMBLY

REASSEMBLE IN REVERSE ORDER OF DISASSEMBLY. NOTE SPECIAL INSTRUCTIONS AND ADJUSTMENTS.

SPECIAL INSTRUCTIONS

IDLE ADJUSTING NEEDLE (115) - TURN IN UNTIL LIGHTLY SEATED, THEN BACK OUT NUMBER OF TURNS RECORDED ON DISASSEMBLY. (DO NOT INSTALL ROLL PIN & PLUG AT THIS TIME.)

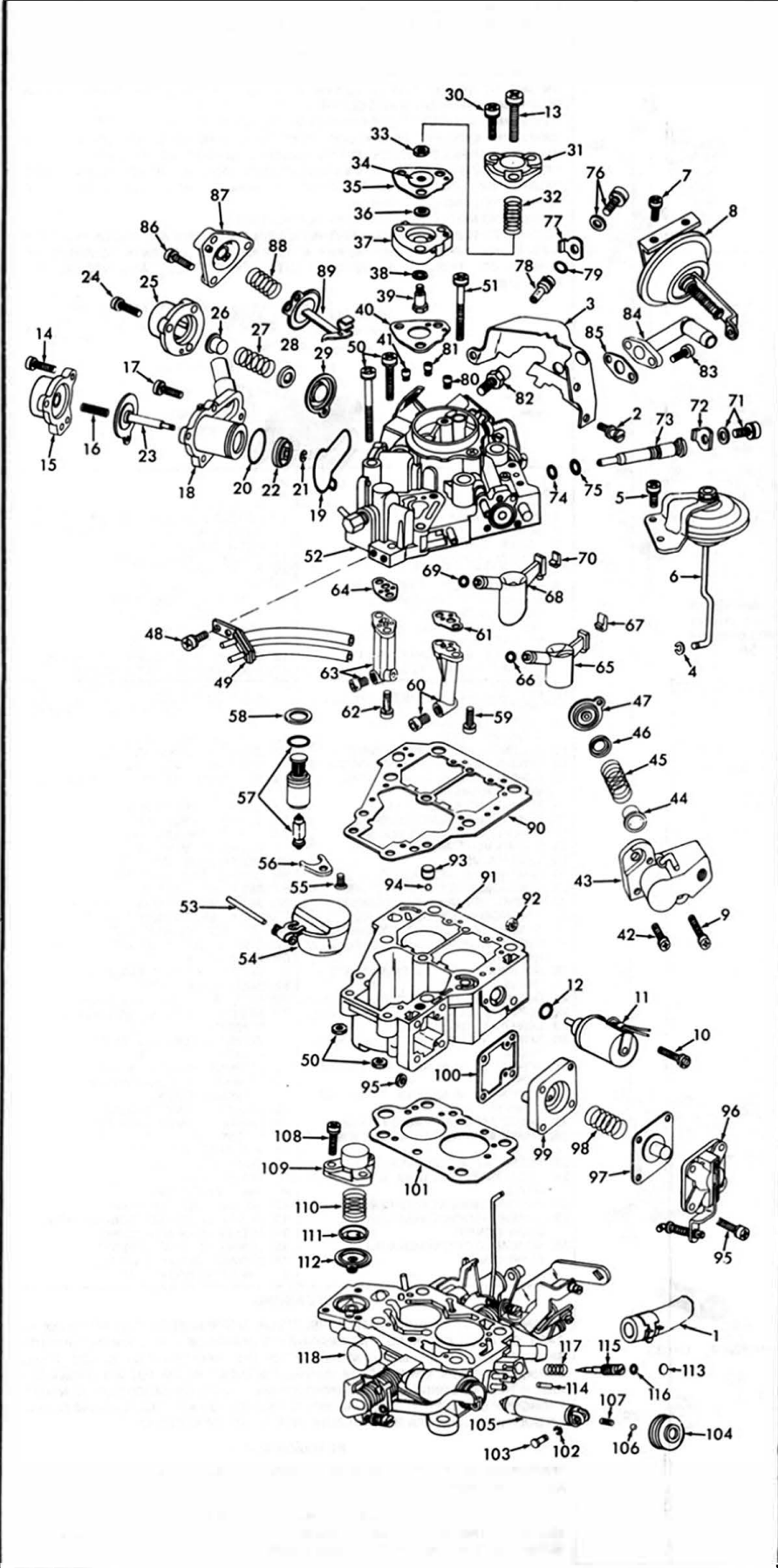

INSTRUCTION SHEET

OFF VEHICLE CARBURETOR SERVICE

MIKUNI (FEEDBACK) - MODELS 28-32, 32-35 DIDTF

GENERAL EXPLODED VIEW
THE GENERAL DESIGN AND PARTS SHOWN WILL VARY TO INDIVIDUAL UNITS COVERED ON THIS INSTRUCTION SHEET.

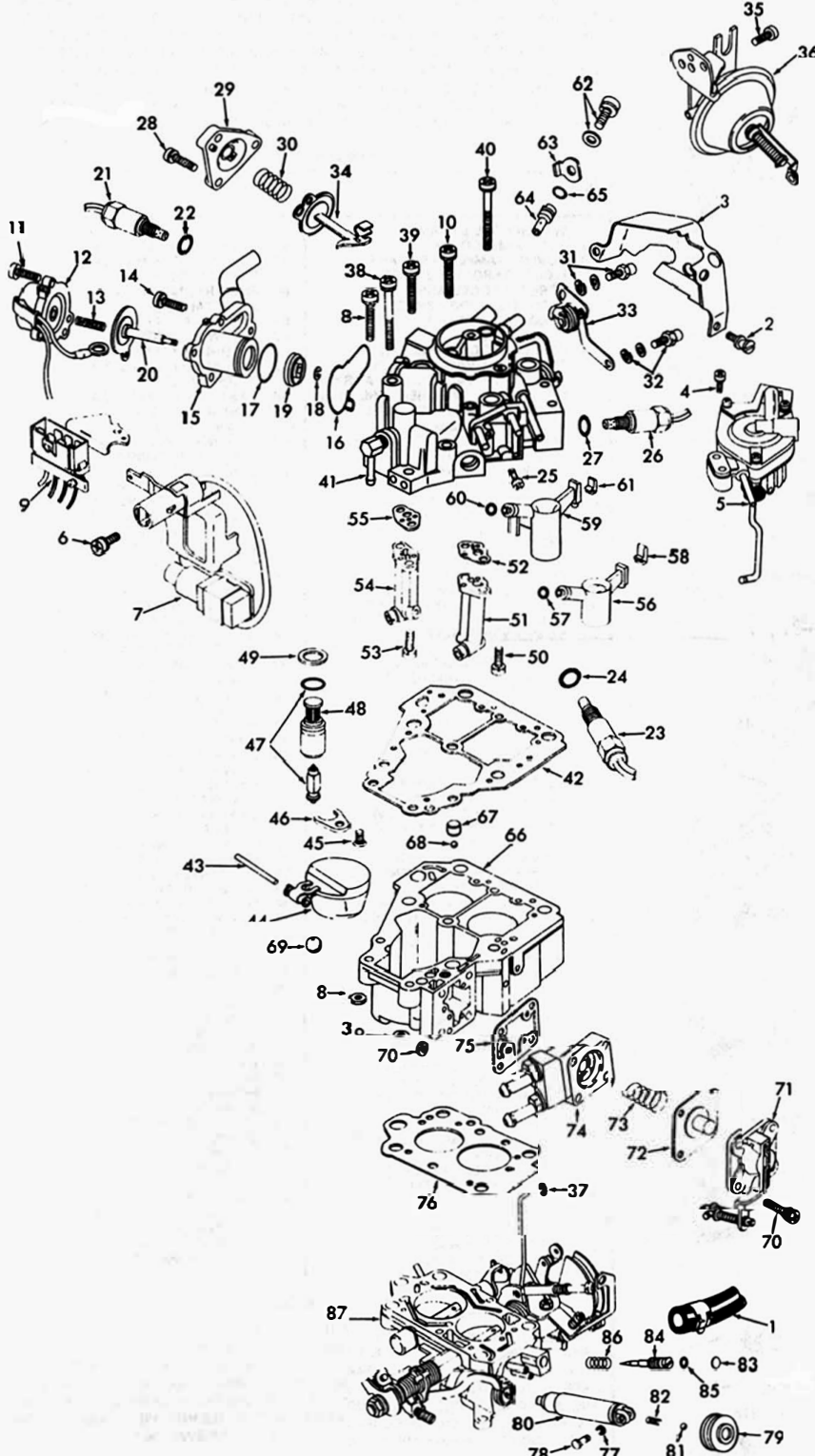

DISASSEMBLY

USE EXPLODED VIEW AS A GUIDE. THE NUMERICAL SEQUENCE MAY GENERALLY BE FOLLOWED TO DISASSEMBLE UNIT FAR ENOUGH TO PERMIT CLEANING AND INSPECTION. CAUTION: ALL DIAPHRAGMS ARE NOT REPAIR KIT REPLACEMENT PARTS. HANDLE CAREFULLY, THEY WILL BE USED OVER.

SPECIAL NOTES

TO REMOVE CHOKE COVER, GRIND OR FILE OFF THE 2 ROLLED OVER SCREW HEADS ON SIDE OF COVER. SAW A SCREWDRIVER SLOT IN THE 3 BREAKAWAY SCREW HEADS. REMOVE SCREWS AND COVER.
ROD & LINK ENDS OR A SNAP FIT IN PLASTIC BUSHINGS.
MARK AND IDENTIFY JET MIXTURE, ENRICHMENT, AND DECELERATION SOLENOID VALVES WHEN REMOVING. (SEE SPECIAL SOLENOID SERVICE INSTRUCTIONS)
AFTER REMOVING CHOKE PINION & BRACKET ASSY., REMOVE CHOKE BREAKER DIAPHRAGM ASSY., THEN TEMPORARILY INSTALL BRACKET WITH LOWER SCREW TO RETAIN LEVER AND LARGE SPRING.
SCREEN AND NEEDLE SEAT SHIM WILL BE USED OVER
TO REMOVE IDLE ADJUSTING NEEDLE PLUG DRILL AS SHOWN AND KNOCK OUT WITH A PIN PUNCH. BEFORE REMOVING IDLE ADJUSTING NEEDLE, TURN IN COUNTING THE NUMBER OF TURNS IT TAKES TO LIGHTLY SEAT NEEDLE AND RECORD FOR REASSEMBLY.

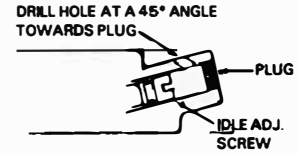

NOMENCLATURE

REF. NO.	REF. NO.
1 WATER HOSE & CLAMP	40. SCREW & LOCKWASHER (2) - BOWL COVER (CENTER AIR HORN)
2 SCREW (3) - COVER	41 BOWL COVER ASSY.
3 COVER - CHOKE	42 GASKET - BOWL COVER
4 SCREW & LOCKWASHER (2) - ACTUATOR	43 PIN - FLOAT
5 DASHPOT & IDLE UP ACTUATOR	44. FLOAT & LEVER ASSY.
6 SCREW & LOCKWASHER (2) - THROTTLE SENSOR	45. SCREW & LOCKWASHER - NEEDLE SEAT RETAINER
7 THROTTLE POSITION SENSOR & BRACKET ASSY.	46. RETAINER - NEEDLE SEAT
8 SCREW, LOCKWASHER & NUT - CONNECTOR BRACKET	47. NEEDLE & SEAT ASSY.
9 CONNECTOR & BRACKET ASSY.	48. SCREEN - NEEDLE SEAT (USE OVER)
10 SCREW & LOCKWASHER - BOWL VENT GRD. WIRE	49. SHIM - NEEDLE SEAT (USE OVER)
11 SCREW & LOCKWASHER (3) - BOWL VENT SOLENOID	50. SCREW & LOCKWASHER (2) - PRIMARY PEDESTAL
12 SOLENOID ASSY. - BOWL VENT	51. PRIMARY MAIN JET & PEDESTAL ASSY.
13 SPRING - BOWL VENT DIAPHRAGM	52. GASKET - PRI. PEDESTAL
14 SCREW & LOCKWASHER - BOWL VENT HOUSING	53. SCREW & LOCKWASHER (2) - SECONDARY PEDESTAL
15 BOWL VENT HOUSING ASSY.	54. SECONDARY MAIN JET & PEDESTAL ASSY.
16 SEAL - VENT VALVE HOUSING	55. GASKET - SEC. PEDESTAL
17 O-RING - VENT VALVE HOUSING	56. VENTURI - PRIMARY
18 E-CLIP - VENT VALVE	57. O-RING - PRI. VENTURI
19 VENT VALVE	58. RETAINER - VENTURI
20 DIAPHRAGM - VENT VALVE	59. VENTURI - SECONDARY
21 SOLENOID ASSY. - JET MIXTURE	60. O-RING - SEC. VENTURI
22 O-RING - JET MIXTURE SOLENOID	61. RETAINER - VENTURI
23 SOLENOID ASSY. - ENRICHMENT	62. SCREW & WASHERS - LOCK
24 O-RING - ENRICHMENT SOLENOID	63. LOCK - SECONDARY PILOT JET
25 SCREW & LOCKWASHER - BRACKET (LOOM)	64. JET - SECONDARY PILOT
26 SOLENOID ASSY. - DECELERATION VALVE	65. O-RING - SEC. PILOT JET
27 O-RING - DECELERATION SOLENOID	66. BOWL ASSY. - FUEL
28 SCREW & LOCKWASHER (3) - COVER	67. WEIGHT - PUMP CHECK BALL
29 COVER - CHOKE BREAKER	68. BALL - PUMP CHECK
30 SPRING - CHOKE BREAKER DIAPHRAGM	69. BALL - ANTI OVERFILL DEVICE
31 SCREW & WASHERS - BRACKET (UPPER)	70. SCREW, LOCKWASHER & NUT (4) - PUMP COVER
32 SCREW & WASHERS - BRACKET (LOWER)	71. COVER, LEVER & LINK ASSY. - PUMP
33 CHOKE PINION & BRACKET ASSY.	72. DIAPHRAGM ASSY. - PUMP
34 DIAPHRAGM ASSY. - CHOKE BREAKER	73. SPRING - PUMP DIAPHRAGM
35 SCREW & LOCKWASHER - BRACKET	74. HOUSING - PUMP
36 SECONDARY VACUUM & BRACKET ASSY.	75. GASKET - PUMP HOUSING
37 E-CLIP - CHOKE ROD (UPPER)	76. GASKET - THROTTLE BODY
38 SCREW, LOCKWASHER & NUT - BOWL COVER	77. E-CLIP - PIN
39 SCREW, LOCKWASHER & NUT - BOWL COVER	78. PIN - SUB EGR VALVE
	79. BOOT - EGR VALVE
	80. VALVE - EGR
	81. BALL - EGR VALVE
	82. SPRING - EGR VALVE BALL
	83. PLUG - IDLE NEEDLE CONCEALMENT
	84. NEEDLE - IDLE ADJUSTING
	85. O-RING - IDLE ADJ. NEEDLE
	86. SPRING - IDLE ADJ. NEEDLE
	87. THROTTLE BODY ASSY.

CLEANING

CLEANING MUST BE DONE WITH CARBURETOR DISASSEMBLED. DO NOT SOAK IN CARB. CLEANER! CLEAN ALL THE PASSAGES & BODIES OF THE CARBURETOR WITH SPRAY CARBURETOR CLEANER. MAKE CERTAIN THE THROTTLE BODY IS FREE OF ALL CARBON DEPOSITS. WASH OFF IN SUITABLE SOLVENT. BLOW OUT ALL PASSAGES AND JETS IN CASTINGS WITH COMPRESSED AIR AND CHECK CAREFULLY TO INSURE THOROUGH CLEANING OF OBSCURE AREAS. CAUTION: DO NOT USE CLEANING FLUIDS ON SOLENOIDS, DIAPHRAGMS, RUBBER PARTS, FLOAT OR SWITCHES.

REASSEMBLY

REASSEMBLE IN REVERSE ORDER OF DISASSEMBLY. NOTE SPECIAL INSTRUCTIONS AND ADJUSTMENTS.

SPECIAL INSTRUCTIONS

IDLE ADJUSTING NEEDLE (84) - TURN IN UNTIL LIGHTLY SEATED. THEN BACK OUT NUMBER OF TURNS RECORDED ON DISASSEMBLY.

ADJUSTMENTS

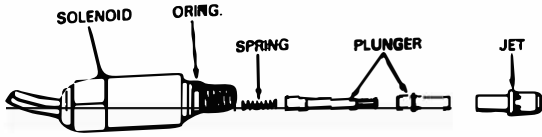

JET PARTS CAN BE REMOVED FROM SOLENOID (PRESS FIT) AND CLEAN WITH A SPRAY CLEANER. BEING VERY CAREFUL OF SPRING VERY FRAGILE

SOLENOID CLEANING

PAGE 1

SMALL SPRING GUIDE

REF. NO. 16	3/16" x 1"
REF. NO. 27	1/2" x 13/16" HEAVY WIRE
REF. NO. 32	11/32" x 11/16"
REF. NO. 45	1/2" x 1 11/32" HEAVY WIRE
REF. NO. 88	11/32" x 3/4"
REF. NO. 98	7/16" x 1/2"
REF. NO. 110	1/2" x 25/32"
REF. NO. 117	3/16" x 1/2"

PAGE 2

SMALL SPRING GUIDE

REF. NO. 13	7/32" x 1"
REF. NO. 30	11/32" x 3/4"
REF. NO. 72	7/16" x 1/2"
REF. NO. 85	3/16" x 3/8"

② MEASURE DISTANCE FROM BOTTOM OF FLOAT TO GASKET SURFACE OF BOWL COVER

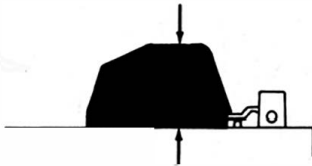

19.8 - 20.MM
+ 1.MM

① AIR HORN INVERTED.(WITHOUT GASKET)

③ IF READING IS NOT WITHIN RANGE. ADJUSTMENT IS MADE BY CHANGING SHIM UNDER NEEDLE SEAT.

DRY FLOAT LEVEL SETTING

FIG. 1

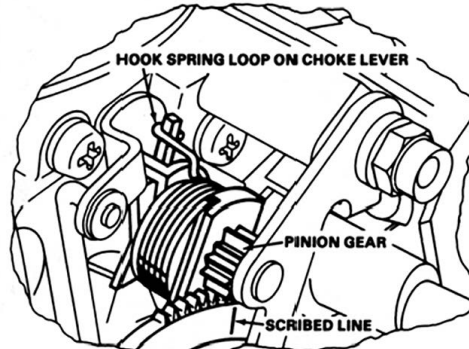

ALIGN THE SCRIBED LINE OR BLACK PAINTED LINE ON TOOTH OF THE CHOKE PINION GEAR, WITH THE SCRIBED LINE ON THE CAM LEVER.

CHOKE PINION & CAM LEVER GEAR TIMING

FIG. 2

ALIGN MARKS ON END OF BRACKET & HOUSING. TIGHTEN LOCK SCREWS.

