

INSTRUCTION SHEET

OFF VEHICLE CARBURETOR SERVICE

HITACHI MODEL DCJ-306-15

GENERAL EXPLODED VIEW

THE GENERAL DESIGN AND PARTS SHOWN WILL VARY TO
INDIVIDUAL UNITS COVERED ON THIS INSTRUCTION SHEET.

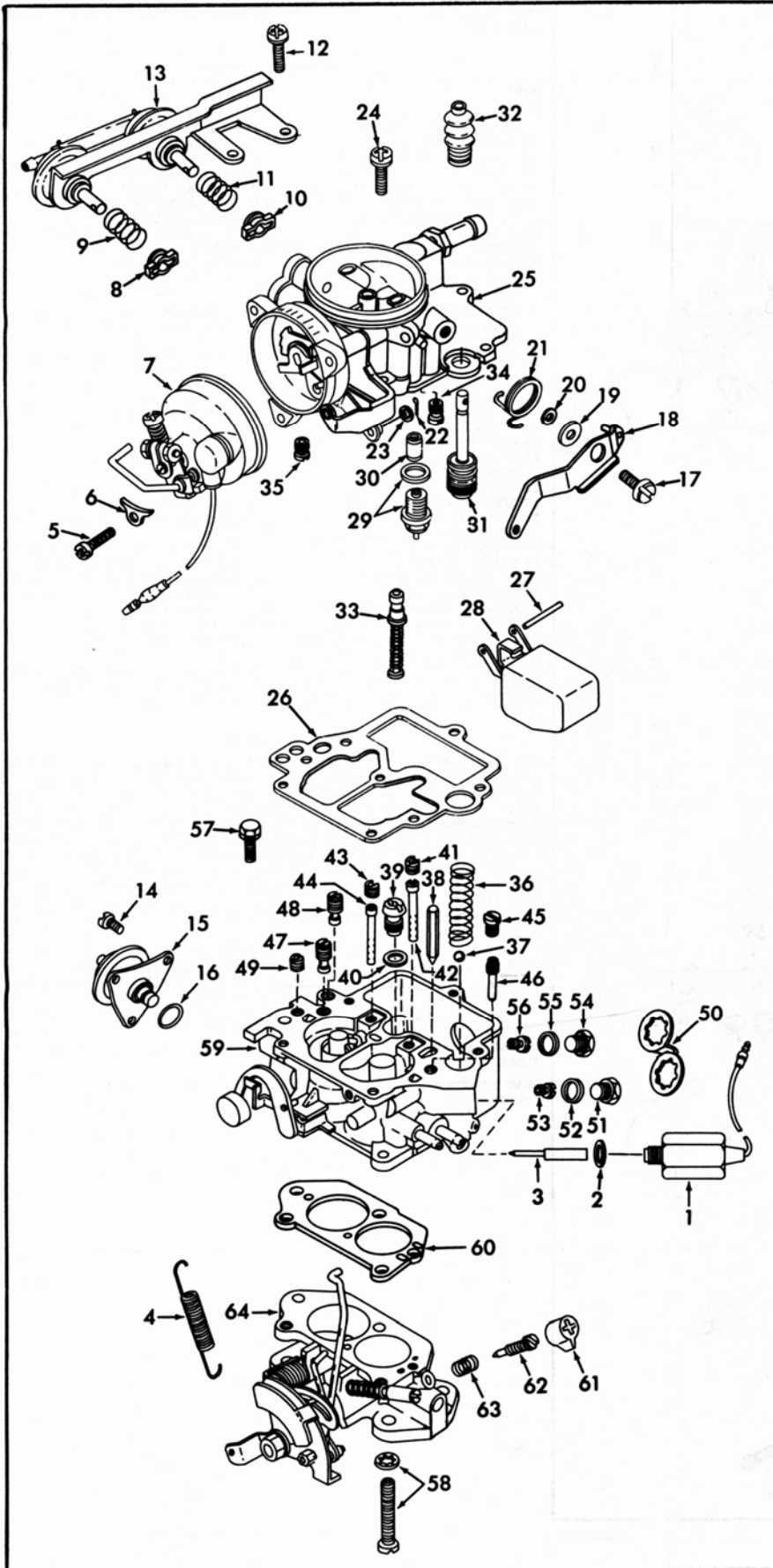

DISASSEMBLY

USE EXPLODED VIEW AS A GUIDE. THE NUMERICAL SEQUENCE MAY GENERALLY BE FOLLOWED TO DISASSEMBLE UNIT FAR ENOUGH TO PERMIT CLEANING AND INSPECTION. REMOVE STAKING FROM BOWL COVER FOR EASY REMOVAL OF POWER PISTON ASSY. (33). CAUTION: NOTE SIZES OF JETS AND THEIR LOCATION FOR PROPER REASSEMBLY. (RECORD SIZES BELOW).

NOMENCLATURE

REF. NO.	REF. NO.
1. SWITCH - ANTI DIESELING	30. SCREEN - NEEDLE SEAT
2. GASKET - SWITCH	31. PUMP ASSY.
3. PLUNGER - SWITCH	32. BOOT - PUMP STEM
4. SPRING - THROTTLE RETURN	33. POWER PISTON ASSY.
5. SCREW (3) - CHOKE COVER	34. JET - PRIMARY SLOW AIR BLEED
6. RETAINER (3) - CHOKE COVER	35. JET - SECONDARY SLOW AIR BLEED
7. CHOKE COVER & LINK ASSY.	36. SPRING - PUMP RETURN
8. HOLDER - SPRING	37. BALL - PUMP CHECK (NYLON)
9. SPRING - AUX. VAC. UNIT (LONG SPRING)	38. NEEDLE - PUMP DISC. CHECK
10. HOLDER - SPRING	39. POWER VALVE
11. SPRING - MAIN VAC. UNIT (SHORT SPRING)	40. GASKET - POWER VALVE
12. SCREW & LKWSHER (2) - VAC. UNIT BRACKET	41. JET - PRIMARY AIR BLEED
13. VAC. UNIT & BRACKET ASSY.	42. TUBE - PRI. EMULSION (SOLID END)
14. SCREW & LKWSHER (3) - BYPASS VALVE	43. JET - SECONDARY AIR BLEED
15. VALVE - THROTTLE BYPASS	44. TUBE - SEC. EMULSION (OPEN END)
16. O-RING - BYPASS VALVE	45. PLUG - PRI. SLOW JET
17. SCREW STUD - PUMP LEVER	46. JET - PRI. SLOW
18. LEVER - PUMP	47. JET - SECONDARY SLOW
19. FLATWASHER - LEVER SCREW	48. JET - THROTTLE BYPASS
20. LKWSHER - LEVER SCREW	49. JET - THROTTLE BYPASS AIR
21. SPRING - PUMP LEVER	50. RETAINER - PLUGS
22. COTTER PIN - CHOKE ROD	51. PLUG - PRIMARY MAIN JET
23. WASHER - CHOKE ROD	52. GASKET - PLUG
24. SCREW & LKWSHER (3) - BOWL COVER	53. JET - PRIMARY MAIN
25. BOWL COVER ASSY.	54. PLUG - SECONDARY MAIN JET
26. GASKET - BOWL COVER	55. GASKET - PLUG
27. PIN - FLOAT	56. JET - SECONDARY MAIN
28. FLOAT & LEVER ASSY.	57. SCREW & LKWSHER (2) - THROTTLE BODY
29. NEEDLE, SEAT & GASKET ASSY.	58. SCREW & LKWSHER (HOLLOW) - THROTTLE BODY
	59. BOWL ASSY.
	60. GASKET - THROTTLE BODY SPACER
	61. CAP - IDLE LIMITER
	62. NEEDLE - IDLE ADJUSTING
	63. SPRING - IDLE ADJ. NEEDLE
	64. THROTTLE BODY ASSY.

CLEANING

CLEANING MUST BE DONE WITH CARBURETOR DISASSEMBLED. SOAK PARTS LONG ENOUGH TO SOFTEN AND REMOVE ALL FOREIGN MATERIAL. USE A CARBURETOR CLEANING SOLVENT. MAKE CERTAIN THE THROTTLE BODY IS FREE OF ALL CARBON DEPOSITS. WASH OFF IN SUITABLE SOLVENT. BLOW OUT ALL PASSAGES IN CASTINGS WITH COMPRESSED AIR AND CHECK CAREFULLY TO INSURE THOROUGH CLEANING OF OBSCURE AREAS. CAUTION: BE VERY CAREFUL NOT TO LEAVE FUEL BOWL ASSY. (59) IN CLEANING SOLVENT TOO LONG BECAUSE OF THE GLASS WINDOW RUBBER SEAL WHICH IS NOT REPLACEABLE. DO NOT SOAK ASSEMBLIES WITH ATTACHED PLASTIC PARTS FOR A LONG PERIOD OF TIME. DO NOT SOAK ANY PARTS CONTAINING RUBBER OR UNITS SUCH AS SWITCH (1), ELECTRIC CHOKE COVER (7), VAC. UNIT (13), VALVE (15), FLOAT (28), IN ANY TYPE OF CLEANING SOLVENT.

REASSEMBLY

REASSEMBLE IN REVERSE ORDER OF DISASSEMBLY. NOTE SPECIAL INSTRUCTIONS AND FOLLOW NUMERICAL OUTLINE IN MAKING ADJUSTMENTS NECESSARY FOR CARBURETOR BEING SERVICED.

SPECIAL INSTRUCTIONS

IDLE ADJUSTING NEEDLE (62) - TURN NEEDLE IN UNTIL LIGHTLY SEATED, THEN BACK OUT 2 - 2 1/2 TURNS. (DO NOT INSTALL IDLE LIMITER CAP AT THIS TIME.)

PUMP RETURN SPRING (36) - INSTALL WITH CROSS WIRE TO THE BOTTOM OF PUMP CYLINDER.

POWER PISTON (33) - AFTER INSTALLING LIGHTLY RESTAKE CASTING AROUND WASHER.

HITACHI CARBURETOR - MODEL DCP 306

GENERAL EXPLODED VIEW
THE GENERAL DESIGN AND PARTS SHOWN WILL VARY TO
INDIVIDUAL UNITS COVERED ON THIS INSTRUCTION SHEET.

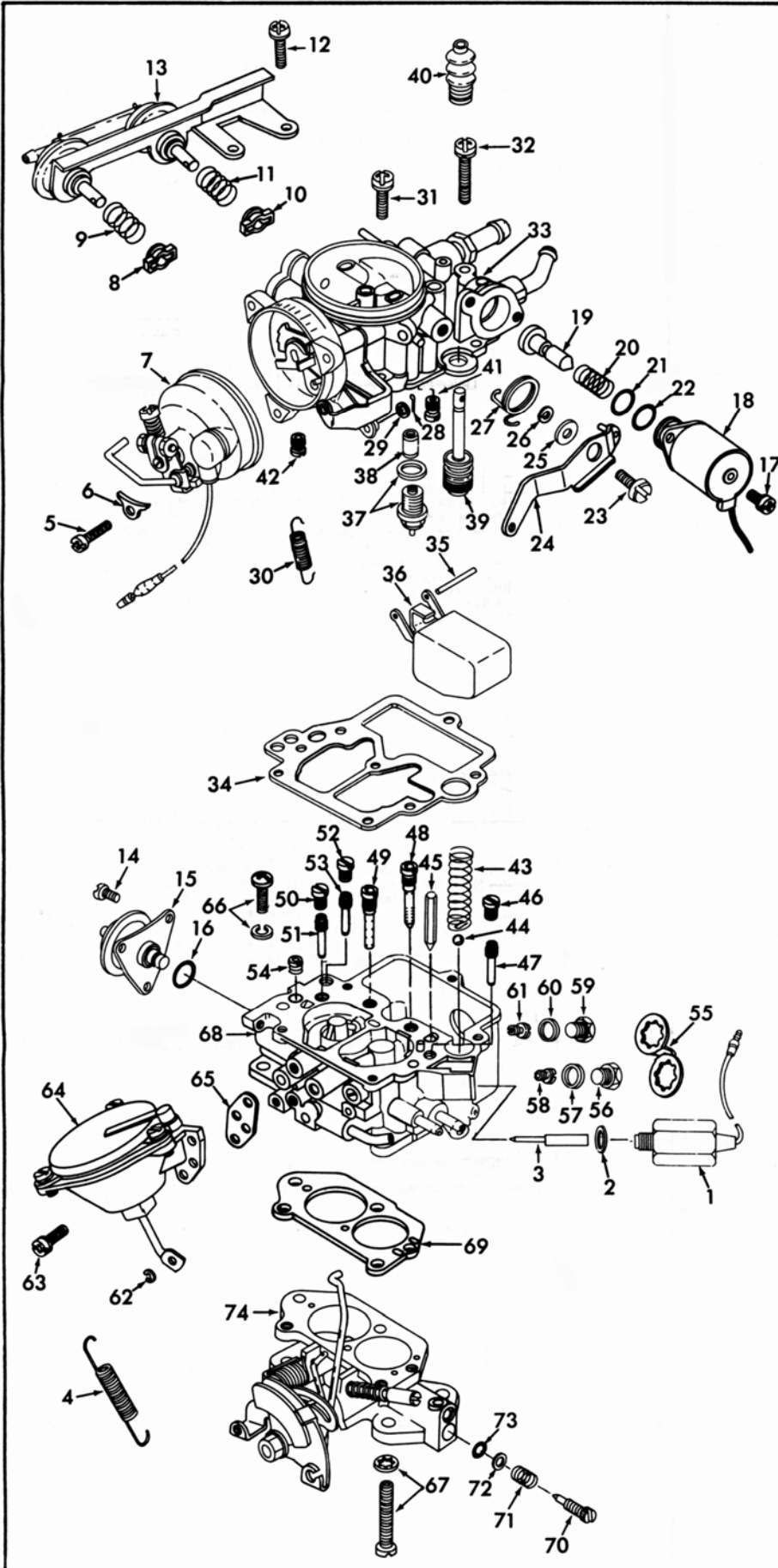

DISASSEMBLY

USE EXPLODED VIEW AS A GUIDE. THE NUMERICAL SEQUENCE MAY GENERALLY BE FOLLOWED TO DISASSEMBLE UNIT FAR ENOUGH TO PERMIT CLEANING AND INSPECTION. CAUTION: NOTE SIZES OF JETS AND THEIR LOCATION FOR PROPER REASSEMBLY. (RECORD SIZES BELOW.)

NOMENCLATURE

REF. NO.	REF. NO.
1. SWITCH - ANTI-DIESELING	37. NEEDLE, SEAT & GASKET ASSY.
2. GASKET - SWITCH	38. SCREEN - NEEDLE SEAT
3. PLUNGER - SWITCH	39. PUMP ASSY.
4. SPRING - THROTTLE RETURN	40. BOOT - PUMP STEM
5. SCREW (3) - CHOKE COVER RETAINER	41. JET - PRIMARY SLOW AIR BLEED
6. RETAINER (3) - CHOKE COVER	42. JET - SECONDARY SLOW AIR BLEED
7. CHOKE COVER & LINK ASSY.	43. SPRING - PUMP RETURN
8. HOLDER - SPRING	44. BALL - PUMP CHECK (NYLON)
9. SPRING - AUX. VAC. UNIT (LONG SPRING)	45. NEEDLE - PUMP DISC CHECK
10. HOLDER - SPRING	46. PLUG - PRI. SLOW JET
11. SPRING - MAIN VAC. UNIT (SHORT SPRING)	47. JET - PRI. SLOW
12. SCREW & LKWSHR. - VAC. UNIT BRACKET	48. JET - PRI. MAIN AIR BLEED
13. VAC. UNIT AND BRACKET ASSY.	49. JET - SEC. MAIN AIR BLEED
14. SCREW & LKWSHR. (3) - BYPASS VALVE	50. PLUG - SEC. SLOW JET
15. VALVE - THROTTLE BYPASS	51. JET - SEC. SLOW
16. O-RING - BYPASS VALVE	52. PLUG - COASTING BYPASS JET
17. SCREW & LKWSHR. (2) - VENT VALVE SOLENOID	53. JET - COASTING BYPASS
18. SOLENOID ASSY. - VENT VALVE	54. JET - COASTING BYPASS AIR BLEED
19. PLUNGER - VENT VALVE	55. RETAINER - PLUG
20. SPRING - PLUNGER	56. PLUG - PRI. MAIN JET
21. O-RING - SOLENOID (OUTER)	57. GASKET - PLUG
22. O-RING - SOLENOID (INNER)	58. JET - PRI. MAIN
23. SCREW STUD - PUMP LEVER	59. PLUG - SEC. MAIN JET
24. LEVER - PUMP	60. GASKET - PLUG
25. FLATWASHER - LEVER SCREW	61. JET - SEC. MAIN
26. LOCKWASHER - LEVER SCREW	62. RETAINER - SEC. DIAPHRAGM
27. SPRING - PUMP LEVER	63. SCREW & LKWSHR. (3) - SEC. DIAPH. ASSY.
28. COTTER PIN - CHOKE ROD	64. DIAPHRAGM ASSY. - SEC. THROTTLE
29. WASHER - CHOKE ROD	65. GASKET - SEC. DIAPHRAGM ASSY.
30. SPRING - SECONDARY RETURN	66. SCREW & LKWSHR. (2) - THROTTLE BODY
31. SCREW & LKWSHR. (2) - BOWL COVER	67. SCREW & LKWSHR. (1) - THROTTLE BODY
32. SCREW & LKWSHR. (1) - BOWL COVER	68. BOWL ASSY.
33. BOWL COVER ASSY.	69. GASKET - THROTTLE BODY
34. GASKET - BOWL COVER	70. NEEDLE - IDLE ADJUSTING
35. PIN - FLOAT	71. SPRING - IDLE NEEDLE
36. FLOAT & LEVER ASSY.	72. WASHER - IDLE NEEDLE (SOME MODELS)
	73. O-RING - IDLE NEEDLE (SOME MODELS)
	74. THROTTLE BODY ASSY.

CLEANING

CLEANING MUST BE DONE WITH CARBURETOR DISASSEMBLED. SOAK PARTS LONG ENOUGH TO SOFTEN AND REMOVE ALL FOREIGN MATERIAL. USE A CARBURETOR CLEANING SOLVENT. MAKE CERTAIN THE THROTTLE BODY IS FREE OF ALL CARBON DEPOSITS. WASH OFF IN SUITABLE SOLVENT. BLOW OUT ALL PASSAGES IN CASTINGS WITH COMPRESSED AIR AND CHECK CAREFULLY TO INSURE THOROUGH CLEANING OF OBSCURE AREAS. CAUTION: BE VERY CAREFUL NOT TO LEAVE FUEL BOWL ASSY. (68) IN CLEANING SOLVENT TOO LONG BECAUSE OF THE GLASS WINDOW RUBBER SEAL WHICH IS NOT REPLACEABLE. DO NOT SOAK ASSEMBLIES WITH ATTACHED PLASTIC PARTS FOR A LONG PERIOD OF TIME. DO NOT SOAK ANY PARTS CONTAINING RUBBER OR UNITS SUCH AS SWITCH (1), ELECTRIC CHOKE COVER (7), VAC. UNIT (13), VALVE (15), SOLENOID (18), PLUNGER (19), FLOAT (36), DIAPHRAGM ASSY. (64) IN ANY TYPE OF CLEANING SOLVENT.

REASSEMBLY

REASSEMBLE IN REVERSE ORDER OF DISASSEMBLY. NOTE SPECIAL INSTRUCTIONS AND FOLLOW NUMERICAL OUTLINE IN MAKING ADJUSTMENTS NECESSARY FOR CARBURETOR BEING SERVICED.

SPECIAL INSTRUCTIONS

IDLE ADJUSTING NEEDLE (70) - TURN NEEDLE IN UNTIL LIGHTLY SEATED, THEN BACK OUT 4 TURNS.

PUMP RETURN SPRING (43) - INSTALL WITH CROSS WIRE TO THE BOTTOM OF PUMP CYLINDER.

ADJUSTMENTS

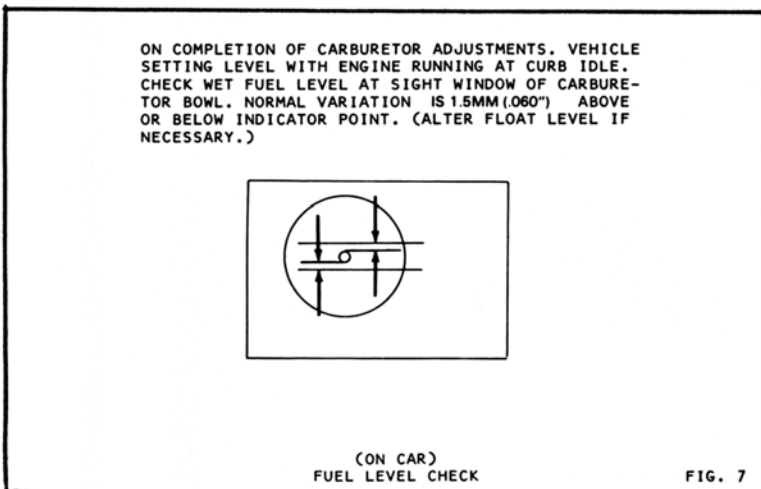
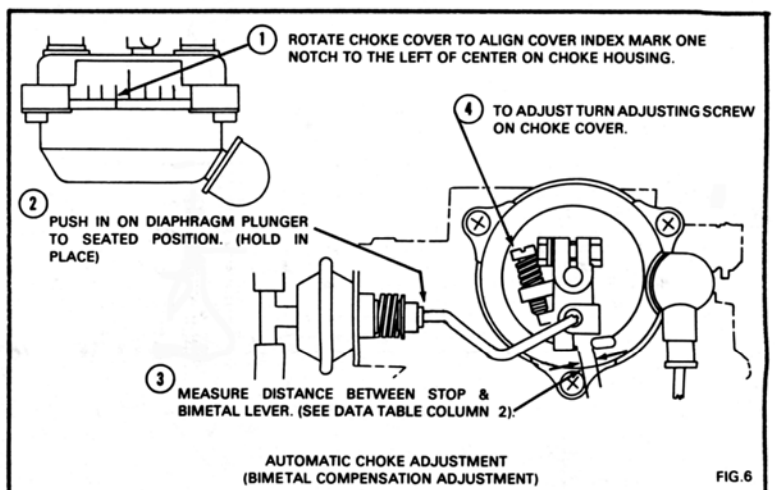
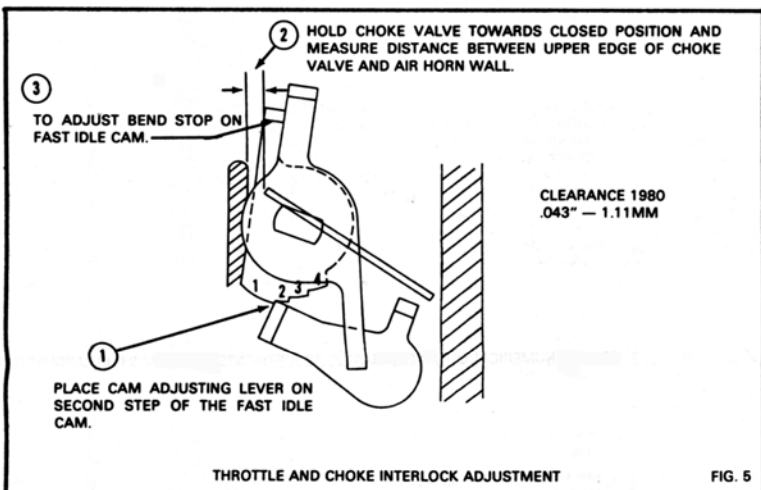
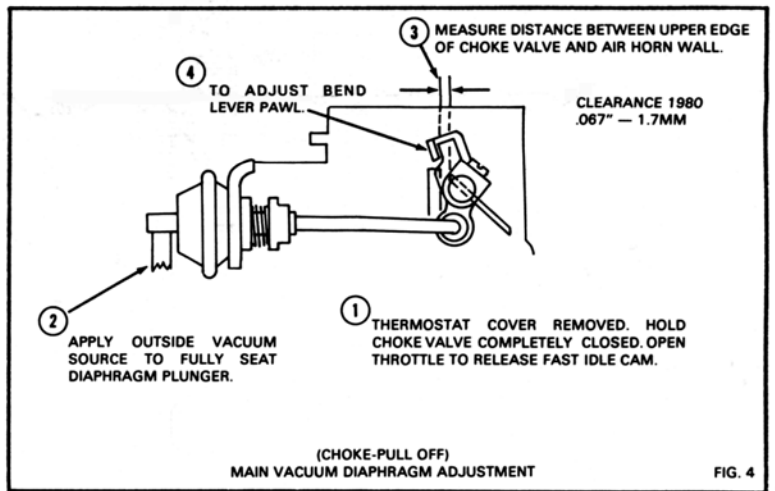
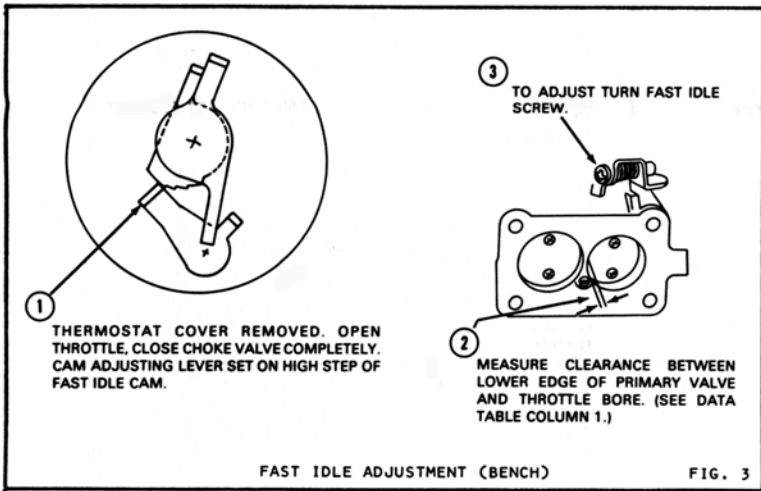
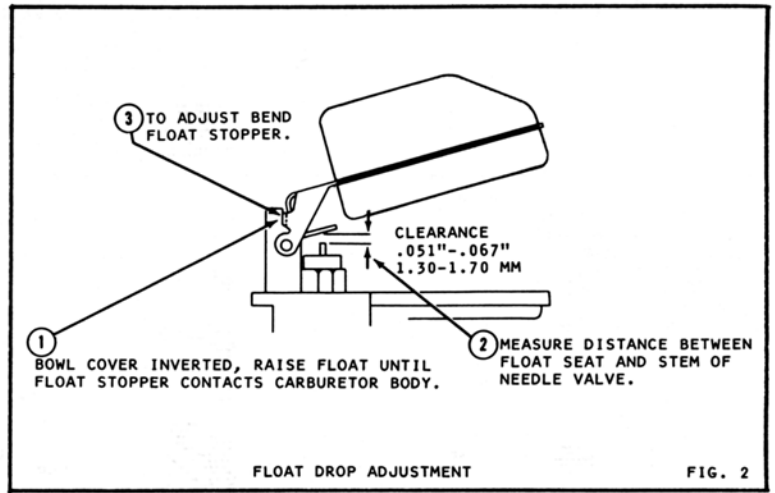
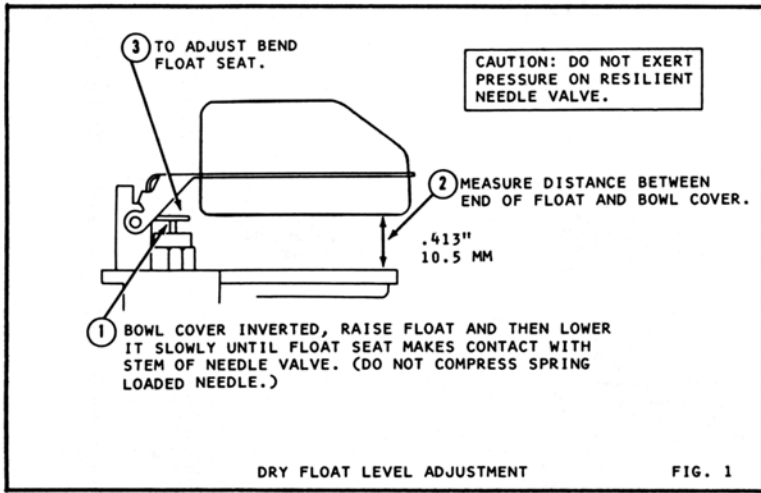

DATA TABLE

CARBURETOR NUMBER	1 FAST IDLE	2 BIMETAL COMPENSATION
DCJ 306-15	.050" - 1.27MM	.484" - 12.3MM
DCP 306-1	.051" - 1.31MM	.484" - 12.3MM
DCP 306-2	.060" - 1.53MM	.484" - 12.3MM
DCP 306-3	.060" - 1.53MM	.484" - 12.3MM
DCP 306-4	.041" - 1.05MM	.378" - 9.6MM
DCP 306-5	.060" - 1.53MM	.484" - 12.3MM