

INSTRUCTION SHEET

S. U. CARBURETORS TYPE HS



DISASSEMBLY

USE EXPLODED VIEW ON REVERSE SIDE AS A GUIDE. THE NUMERICAL SEQUENCE MAY GENERALLY BE FOLLOWED TO DISASSEMBLE UNIT FAR ENOUGH TO PERMIT CLEANING AND INSPECTION. ONLY RUBBER MOUNTED FLOAT CHAMBERS NEED TO BE REMOVED.

CLEANING

CLEANING MUST BE DONE WITH CARBURETOR DISASSEMBLED. SOAK PARTS LONG ENOUGH TO SOFTEN AND REMOVE ALL FOREIGN MATERIAL. USE (1) A CARBURETOR CLEANING SOLVENT, (2) LACQUER THINNER OR (3) DENATURED ALCOHOL. MAKE CERTAIN THE THROTTLE BODY IS FREE OF ALL HARD CARBON DEPOSITS. WASH OFF IN SUITABLE SOLVENT. BLOW OUT ALL PASSAGES IN CASTING WITH COMPRESSED AIR AND CHECK CAREFULLY TO INSURE THOROUGH CLEANING OF OBSCURE AREAS.

CAUTION: DO NOT SOAK RUBBER, LEATHER OR PLASTIC PARTS IN SOLVENT.

REASSEMBLY

REASSEMBLE IN REVERSE ORDER OF DISASSEMBLY. NOTE SPECIAL INSTRUCTIONS AND ADJUSTMENTS.

CAUTION
DO NOT EXERT PRESSURE
ON RESILIENT NEEDLE
VALVE.

(2) BEND HERE TO ADJUST.

GAUGE

(1) NEEDLE SEATED MEASURE BETWEEN FLOAT LEVER AND COVER. GAUGE PLACED ACROSS COVER.

BRASS FLOAT 5/16" 8MM
NYLON FLOAT 1/8" 3MM

FLOAT LEVEL ADJUSTMENT Fig. 1

NOTE: AFTER CARBURETOR IS MOUNTED. REMOVE CAP AND FILL OIL WELL WITH SAE20 TO WITHIN 1/2" OF TOP.

OIL WELL

PLACE SHOULDER OF SHANK FLUSH WITH FACE OF PISTON AND TIGHTEN LOCKSCREW.

PISTON AND NEEDLE ASSEMBLY Fig. 2

(1) INSTALL JET BEARING, WASHER AND LOCKNUT. INSTALL JET ASSEMBLY IN BEARING.

(2) PISTON SHOULD MOVE FREELY UP AND DOWN ITS FULL TRAVEL. IF NOT ADJUST.

(3) TO ADJUST LOOSEN LOCKNUT AND ROTATE BEARING UNTIL FREE MOVEMENT OF PISTON IS FOUND WITH LOCKNUT TIGHT. NOTE: PISTON SHOULD BE AS FREE WITH JET IN PLACE OR REMOVED.

PISTON

LOCKNUT

JET BEARING

JET

CENTERING NEEDLE AND JET Fig. 3

(1) TURN JET ADJUSTING NUT ALL THE WAY UP THEN BACK OFF 2 TURNS.

(2) SET IDLE SPEED R.P.M.

(3) TURN JET ADJUSTING NUT UNTIL THE FASTEST IDLE SPEED IS OBTAINED. RESETTING SLOW IDLE R.P.M. IF NECESSARY.

JET ADJ. NUT.

FAST IDLE SCREW

IDLE ADJUSTMENT ON CAR Fig. 4

GENERAL EXPLODED VIEW

THE GENERAL DESIGN AND PARTS SHOWN WILL VARY TO INDIVIDUAL UNITS COVERED ON THIS INSTRUCTION SHEET

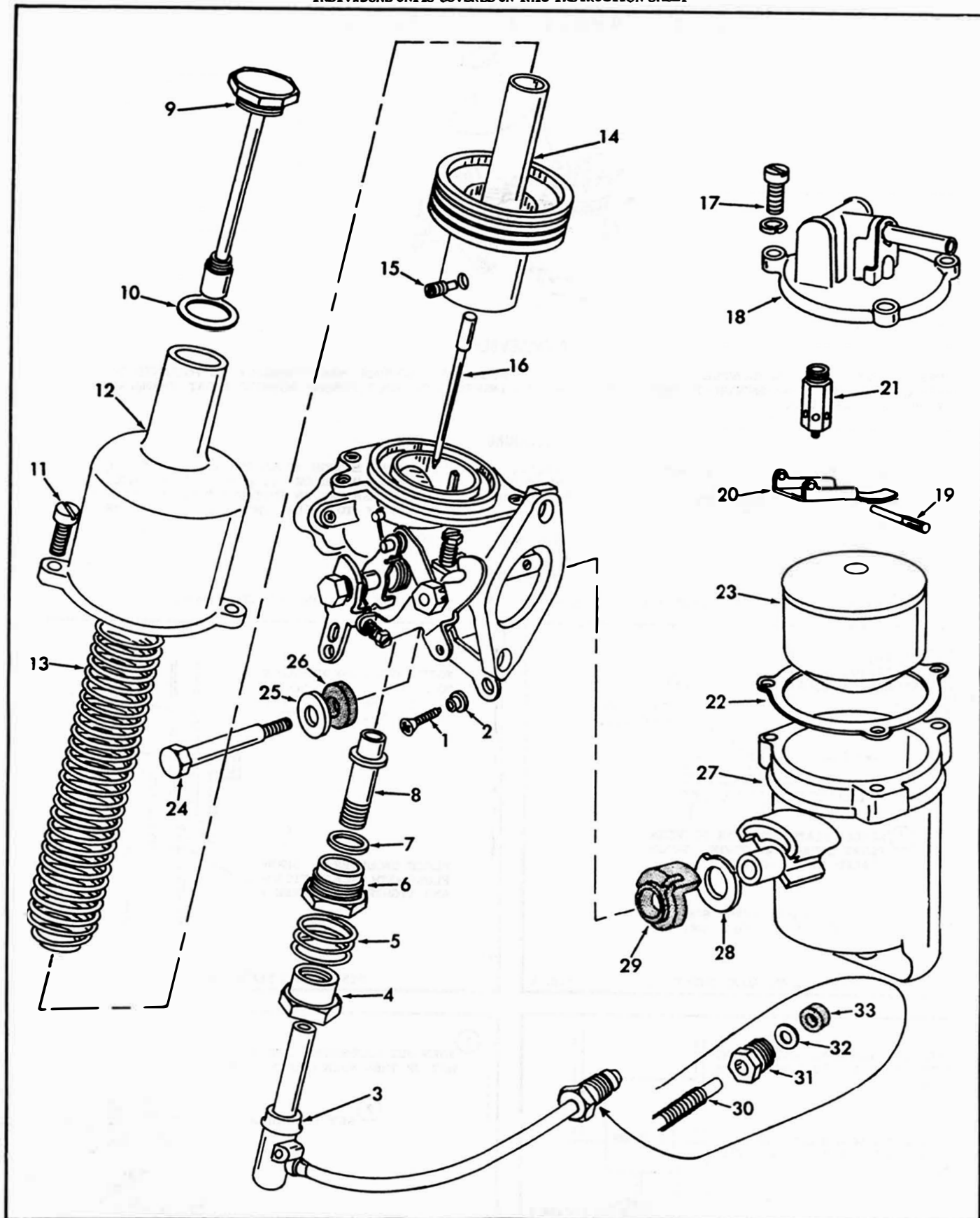

NOMENCLATURE

- | | | | |
|--------------------------------|---------------------------------|---------------------------------|---------------------------------|
| 1. SCREW - LINK TO JET | 11. SCREW - CHAMBER TO BODY (2) | 20. LEVER - FLOAT | 27. FLOAT CHAMBER |
| 2. BUSHING - LINK TO JET SCREW | 12. CHAMBER - PISTON | 21. NEEDLE & SEAT ASSEMBLY | 28. WASHER - SUPPORT |
| 3. JET ASSEMBLY | 13. SPRING - PISTON | 22. GASKET-FLOAT CHAMBER COVER | 29. GROMMET - RUBBER |
| 4. NUT - JET ADJUSTING | 14. PISTON | 23. FLOAT | |
| 5. SPRING - JET LOCKING | 15. SCREW - NEEDLE LOCKING | | |
| 6. NUT - JET LOCKING | 16. NEEDLE | | |
| 7. WASHER - JET BEARING | 17. SCREW & LOCKWASHER - | REMOVE FOLLOWING PARTS IF FLOAT | JET TUBE ATTACHING SOME MODELS |
| 8. BEARING - JET | FLOAT CHAMBER COVER (3) | CHAMBER IS RUBBER MOUNTED | 30. PLASTIC FUEL LINE WITH WIRE |
| 9. CAP & DAMPER ASSEMBLY | 18. COVER - FLOAT CHAMBER | 24. BOLT - FLOAT CHAMBER | SPRING GUARD |
| 10. WASHER - CAP | 19. PIN - FLOAT LEVER | 25. WASHER - STEEL | 31. NUT - FUEL LINE |
| | | 26. WASHER - RUBBER | 32. WASHER - BRASS |
| | | | 33. WASHER - RUBBER |