

INSTRUCTION SHEET

OFF VEHICLE CARBURETOR SERVICE

HOLLEY MODEL - 2300 EG

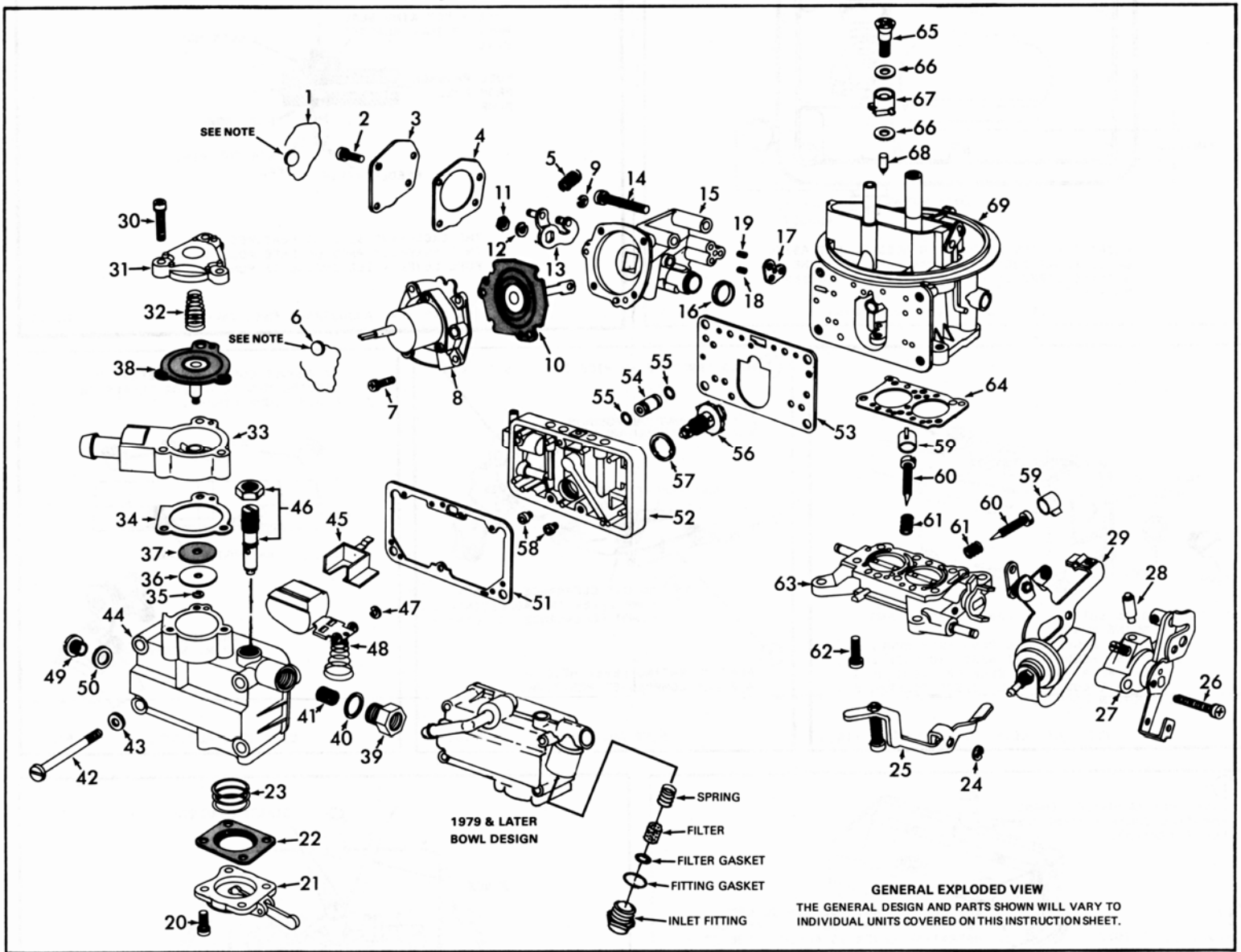

DISASSEMBLY

USE EXPLODED VIEW AS A GUIDE. THE NUMERICAL SEQUENCE MAY GENERALLY BE FOLLOWED TO DISASSEMBLE UNIT FAR ENOUGH TO PERMIT CLEANING AND INSPECTION. NOTE: WHEN REMOVING GOVERNOR BY PASS JETS A AND B (18), (19), RECORD SIZE AND LOCATION FOR PROPER REASSEMBLY. (1982 TAMPERPROOF IDLE MIXTURE SCREW REMOVAL SEE FIG. 8.)

CLEANING

CLEANING MUST BE DONE WITH CARBURETOR DISASSEMBLED. SOAK PARTS LONG ENOUGH TO SOFTEN AND REMOVE ALL FOREIGN MATERIAL. USE A CARBURETOR CLEANING SOLVENT. MAKE CERTAIN THE THROTTLE BORES ARE FREE OF ALL CARBON AND VARNISH DEPOSITS. RINSE OFF IN SUITABLE SOLVENT. BLOW OUT ALL PASSAGES IN CASTINGS WITH COMPRESSED AIR AND CHECK CAREFULLY TO INSURE THOROUGH CLEANING OF OBSCURE AREAS. CAUTION: DO NOT SOAK PARTS CONTAINING RUBBER MATERIALS OR PARTS SUCH AS (8), (10), (16), (46), (48), (56), IN CLEANING SOLVENTS.

REASSEMBLY

REASSEMBLE IN REVERSE ORDER OF DISASSEMBLY. NOTE SPECIAL INSTRUCTIONS AND FOLLOW NUMERICAL OUTLINE IN MAKING ADJUSTMENTS NECESSARY FOR CARBURETOR BEING SERVICED.

SPECIAL INSTRUCTIONS

THROTTLE BODY SCREWS (62)-TIGHTEN IN THREE STAGES CROSSWISE TO ARRIVE AT THE CORRECT TORQUE. (50 INCH POUNDS)

IDLE ADJUSTING SCREWS (60)-TURN IN UNTIL LIGHTLY SEATED, THEN BACK OUT 2 1/2 TURNS. (DO NOT INSTALL IDLE LIMITER CAPS AT THIS TIME). (1982 SEE FIG. 8)

ENRICHMENT VALVE (56)-TORQUE TO 100 INCH POUNDS.

O-RINGS-LIGHTLY LUBRICATE FOR EASIER INSTALLATION.

FUEL BOWL (44)-BEFORE INSTALLING, MAKE DRY FLOAT LEVEL ADJUSTMENT.

BOWL SCREWS AND GASKETS (42), (43)-INSTALL GASKETS ON SCREWS, INSTALL AND TORQUE EVENLY IN STAGES TO 50 INCH POUNDS.

NOTE: ITEM NO. 1 & 6 IS NOT A KIT SERVICE REPLACEMENT PART

NOMENCLATURE

REF. NO.	REF. NO.
1.	34.
2.	35.
3.	36.
4.	37.
5.	38.
6.	39.
7.	40.
8.	41.
9.	42.
10.	43.
11.	44.
12.	45.
13.	46.
14.	47.
15.	48.
16.	49.
17.	50.
18.	51.
19.	52.
20.	53.
21.	54.
22.	55.
23.	56.
24.	57.
25.	58.
26.	59.
27.	60.
28.	61.
29.	62.
30.	63.
31.	64.
32.	65.
33.	66.
	67.
	68.
	69.

GENERAL EXPLODED VIEW
THE GENERAL DESIGN AND PARTS SHOWN WILL VARY TO INDIVIDUAL UNITS COVERED ON THIS INSTRUCTION SHEET.

ADJUSTMENTS

