

INSTRUCTION SHEET OFF VEHICLE CARBURETOR SERVICE KEIHIN - (HONDA CVCC ENGINE 1976-77)

50-542

GENERAL EXPLODED VIEW

THE GENERAL DESIGN AND PARTS SHOWN WILL VARY TO
INDIVIDUAL UNITS COVERED ON THIS INSTRUCTION SHEET.

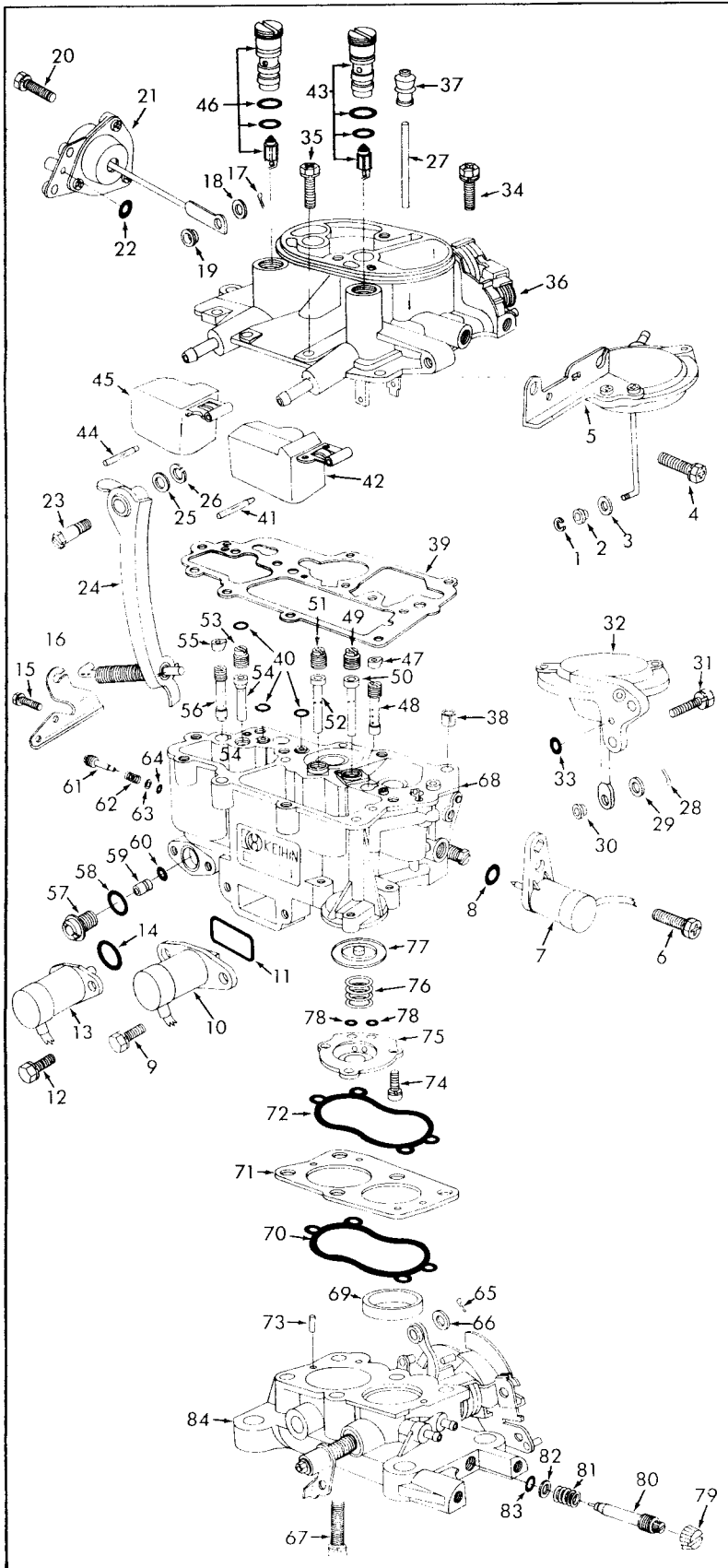

DISASSEMBLY

USE EXPLODED VIEW AS A GUIDE. THE NUMERICAL SEQUENCE MAY GENERALLY BE FOLLOWED TO DISASSEMBLE UNIT FAR ENOUGH TO PERMIT CLEANING AND INSPECTION. NOTE: TO REMOVE FLOAT PINS (41) (44), CAREFULLY SUPPORT SHORT BOSS (FLOAT PIN SUPPORT). USING A 3/32" PIN PUNCH & HAMMER, TAP PIN TOWARDS SHORT BOSS. INSIDE END HAS A TAPER WHICH FITS SNUG IN LONG BOSS. RECORD SIZES OF JETS AND TUBES (BELOW) FOR PROPER REASSEMBLY. AUXILIARY IDLE MIXTURE NEEDLE (61) BEFORE REMOVING TURN IN COUNTING THE NUMBER OF TURNS IT IS FROM THE SEATED POSITION. IDLE LIMITER CAP (79) CAN BE CAREFULLY PULLED OFF IDLE ADJUSTING NEEDLE (WILL BE USED OVER).

NOMENCLATURE

| REF. NO. | REF. NO. |
|---|--|
| 1. E CLIP - T.C. ROD | **40. O-RING (3) - AUXILIARY PASSAGE SEALS |
| 2. BUSHING - T.C. ROD | 41. PIN - MAIN FLOAT |
| 3. WASHER - T.C. ROD | 42. FLOAT - MAIN |
| 4. SCREW & LKWSHR. (2) - BRACKET T.C. | 43. NEEDLE & SEAT ASSEMBLY - MAIN |
| 5. THROTTLE CONTROLLER DIAPHRAGM ASSEMBLY | 44. PIN - AUXILIARY FLOAT |
| 6. SCREW & LKWSHR. - SOLENOID | 45. FLOAT - AUXILIARY |
| 7. SOLENOID - IDLE CUTOFF | 46. NEEDLE & SEAT ASSEMBLY - AUXILIARY |
| 8. O-RING - SOLENOID MOUNTING | 47. CAP (BLACK) - PRIMARY SLOW JET |
| 9. SCREW & LOCKTAB (2) - SOLENOID | 48. JET - PRIMARY SLOW |
| 10. SOLENOID - PRIMARY MAIN JET CUTOFF | 49. JET - PRIMARY MAIN AIR BLEED |
| 11. O-RING - SOLENOID MOUNTING | *50. TUBE - PRIMARY EMULSION |
| **12. SCREW & LOCKTAB (2) SOLENOID | 51. JET - SECONDARY MAIN AIR BLEED |
| **13. SOLENOID - AUXILIARY JET CUTOFF | 52. TUBE - SECONDARY EMULSION |
| **14. O-RING - SOLENOID MOUNTING | *53. TUBE - AUXILIARY MAIN AIR BLEED |
| 15. SCREW & LKWSHR. - BRACKET | *54. TUBE - AUXILIARY EMULSION |
| 16. BRACKET - THROTTLE CABLE | 55. CAP (WHITE) - AUXILIARY SLOW JET |
| 17. COTTER PIN - CHOKE OPENER ROD | 56. JET - AUXILIARY SLOW |
| 18. WASHER - CHOKE OPENER ROD | *57. PLUG - AUXILIARY MAIN JET |
| 19. BUSHING - CHOKE OPENER ROD | *58. O-RING - PLUG |
| 20. SCREW & LKWSHR. (2) - CHOKE OPENER | *59. JET - AUXILIARY MAIN |
| 21. CHOKE OPENER DIAPHRAGM ASSEMBLY | **60. O-RING - AUXILIARY MAIN JET |
| 22. O-RING - CHOKE OPENER MOUNTING | 61. NEEDLE - AUXILIARY IDLE MIXTURE |
| 23. SCREW - PUMP LEVER | 62. SPRING - AUXILIARY IDLE NEEDLE |
| 24. PUMP LEVER & ROD ASSEMBLY | 63. WASHER - AUXILIARY IDLE NEEDLE |
| 25. WASHER - LEVER SCREW | 64. O-RING - AUXILIARY IDLE NEEDLE |
| 26. LOCKWASHER - LEVER SCREW | 65. COTTER PIN - AUXILIARY THROTTLE LINK |
| 27. ROD - PUMP | 66. WASHER - AUXILIARY THROTTLE LINK |
| 28. COTTER PIN - SECONDARY DIAPHRAGM ROD | 67. SCREW & LKWSHR. (5) - THROTTLE BODY |
| 29. WASHER - SECONDARY DIAPHRAGM ROD | 68. BOWL ASSEMBLY |
| 30. BUSHING - SECONDARY DIAPHRAGM ROD | 69. RING - ALIGNMENT |
| 31. SCREW & LKWSHR. (2) - SECONDARY DIAPHRAGM ASSEMBLY | 70. O-RING - THROTTLE BODY |
| 32. SECONDARY DIAPHRAGM ASSEMBLY | **71. SPACER - THROTTLE BODY |
| 33. O-RING - SECONDARY DIAPHRAGM ASSY. | **72. O-RING - THROTTLE BODY |
| 34. SCREW, LKWSHR. & FLAT WASHER (2) - BOWL COVER LOCATOR PIN HOLES | 73. PINS - LOCATOR |
| 35. SCREW & LKWSHR. (8) - BOWL COVER | 74. SCREW & LKWSHR. (3) - COVER |
| 36. BOWL COVER ASSEMBLY | 75. COVER - PUMP DIAPHRAGM |
| 37. BOOT - PUMP ROD | 76. SPRING - DIAPHRAGM RETURN |
| 38. PIN (2) - LOCATOR | 77. DIAPHRAGM - PUMP |
| 39. GASKET - BOWL COVER ASSEMBLY | 78. O-RING (2) - PUMP PASSAGE |
| | 79. CAP - IDLE LIMITER |
| | 80. NEEDLE - PRIMARY IDLE ADJUSTING |
| | 81. SPRING - IDLE ADJUSTING NEEDLE |
| | 82. WASHER - IDLE ADJUSTING NEEDLE |
| | 83. O-RING - IDLE ADJUSTING NEEDLE |
| | 84. THROTTLE BODY ASSEMBLY |

* - 1976 Models
** - 1977 Models

CLEANING

CLEANING MUST BE DONE WITH CARBURETOR DISASSEMBLED. SOAK PARTS LONG ENOUGH TO SOFTEN AND REMOVE ALL FOREIGN MATERIAL. USE A CARBURETOR CLEANING SOLVENT. MAKE CERTAIN THE THROTTLE BODY IS FREE OF ALL CARBON DEPOSITS. WASH OFF IN SUITABLE SOLVENT. BLOW OUT ALL PASSAGES AND JETS IN CASTINGS WITH COMPRESSED AIR AND CHECK CAREFULLY TO INSURE THOROUGH CLEANING OF OBSCURE AREAS. CAUTION: DO NOT SOAK DIAPHRAGM OR SOLENOID ASSEMBLIES (5), (7), (10), (13), (21), (32), FLOAT (42), (45) OR PARTS MADE OF RUBBER IN ANY TYPE OF CLEANING SOLVENT.

REASSEMBLY

REASSEMBLE IN REVERSE ORDER OF DISASSEMBLY. NOTE SPECIAL INSTRUCTIONS AND ADJUSTMENTS.

SPECIAL INSTRUCTIONS

IDLE ADJUSTING NEEDLE (80) - TO INSTALL FIRST ASSEMBLE SPRING (81), WASHER (82), O-RING (83), ON NEEDLE. TURN NEEDLE IN UNTIL LIGHTLY SEATED THEN BACK OUT 2 TURNS. (DO NOT INSTALL IDLE LIMITER CAP AT THIS TIME.)

THROTTLE BODY ASSEMBLY (84) - WHEN INSTALLING IT TO BOWL ASSEMBLY BE SURE TO HOOK UP AUXILIARY THROTTLE LINK.

AUXILIARY IDLE ADJUSTING NEEDLE (61) - TO INSTALL FIRST ASSEMBLE SPRING (62), WASHER (63), O-RING (64), ON NEEDLE. TURN NEEDLE IN UNTIL LIGHTLY SEATED THEN BACK OUT NUMBER OF TURNS COUNTED ON DISASSEMBLY. (IF ORIGINAL SCREW POSITION IS NOT KNOWN, TURN THE SCREW 1/4 TURNS OUT FROM SEATED POSITION.)

NEEDLE & SEAT ASSEMBLIES (46) (43) - AFTER FLOAT LEVELS HAVE BEEN ADJUSTED BE SURE TO SEAL SCREW HEADS WITH AN EPOXY SEALER TO PREVENT TURNING OF NEEDLE SEAT.

FLOAT PINS (41) (44) - INSTALL WITH TAPERED END TOWARDS LONG BOSS (CENTER OF BOWL COVER).

PUMP ROD BOOT (37) - ENGAGE BOOT LIP SECURELY IN BOWL COVER CAVITY BEFORE INSTALLING BOWL COVER.

BOWL COVER SCREWS (34) (35) - TIGHTEN SCREWS FROM THE CENTER OUT.

ADJUSTMENTS

