

INSTRUCTION SHEET

OFF VEHICLE CARBURETOR SERVICE

HOLLEY MODEL - 5200

GENERAL EXPLODED VIEW

THE GENERAL DESIGN AND PARTS SHOWN WILL VARY TO
INDIVIDUAL UNITS COVERED ON THIS INSTRUCTION SHEET

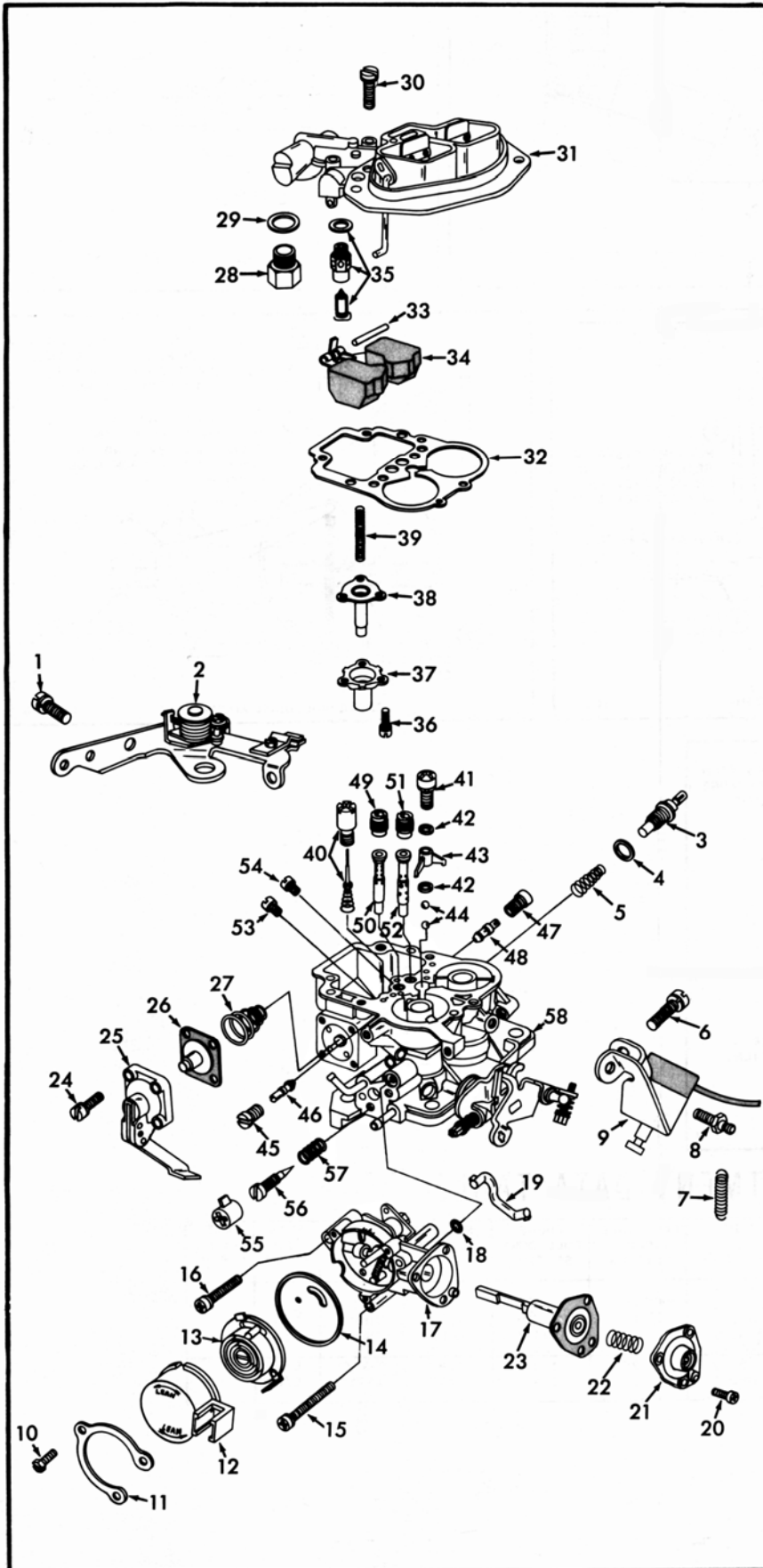

DISASSEMBLY

USE EXPLODED VIEW AS A GUIDE. THE NUMERICAL SEQUENCE MAY GENERALLY BE FOLLOWED TO DISASSEMBLE UNIT FAR ENOUGH TO PERMIT CLEANING AND INSPECTION. CAUTION: NOTE SIZES OF JETS, MAIN WELL TUBES AND THEIR LOCATION FOR PROPER ASSY. (RECORD SIZES BELOW.)

NOMENCLATURE

REF. NO.	REF. NO.
1. SCREW & LOCKWASHER (2)- BRACKET	29. GASKET- FITTING
2. BELL CRANK MECHANISM	30. SCREW & LOCKWASHER (5)- BOWL COVER
3. PLUNGER ASSY.- ALTITUDE COMPENSATOR	31. BOWL COVER ASSY.
4. GASKET- PLUNGER ASSY.	32. GASKET- BOWL COVER
5. SPRING- PLUNGER RETURN	33. PIN- FLOAT HINGE
6. SCREW & LOCKWASHER- SOLENOID BRACKET	34. FLOAT ASSY.
7. SPRING- SECONDARY PICKUP RETURN	35. NEEDLE, SEAT & GASKET ASSY.
8. STUD & LOCKWASHER- SPRING	36. SCREW & LOCKWASHER (3)- COVER
9. SOLENOID ASSY.	37. COVER- DIAPHRAGM
10. SCREW (3)- CHOKE COVER RETAINER	38. DIAPHRAGM ASSY.- POWER VALVE ACTUATOR
11. RETAINER- CHOKE COVER	39. SPRING- DIAPHRAGM
12. COVER- CHOKE COIL	40. POWER VALVE ASSY.
13. COIL ASSY.- CHOKE	41. SCREW- PUMP NOZZLE
14. INSULATOR GASKET- COIL ASSY.	42. GASKET (2)- PUMP NOZZLE
15. SCREW & LOCKWASHER (1)- CHOKE HOUSING (LONG)	43. NOZZLE- PUMP DISCHARGE
16. SCREW & LOCKWASHER (2)- CHOKE HOUSING	44. BALL (2)- PUMP DISCHARGE CHECK
17. CHOKE HOUSING ASSY.	45. RETAINER- PRI. IDLE JET
18. O-RING - CHOKE HOUSING	46. JET- PRI. IDLE
19. ROD- FAST IDLE	47. RETAINER- SEC. IDLE JET
20. SCREW & LOCKWASHER (3)- DIAPHRAGM COVER	48. JET- SEC. IDLE
21. COVER ASSY.- DIAPHRAGM	49. JET- PRI. HIGH SPEED AIR
22. SPRING- DIAPHRAGM RETURN	50. TUBE- PRI. MAIN WELL
23. DIAPHRAGM ASSY.- CHOKE	51. JET- SEC. HIGH SPEED AIR
24. SCREW & LOCKWASHER (4)- PUMP COVER	52. TUBE- SEC. MAIN WELL
25. COVER ASSY.- PUMP	53. JET- PRI. MAIN
26. DIAPHRAGM ASSY.- PUMP	54. JET- SEC. MAIN
27. SPRING- DIAPHRAGM RETURN	55. CAP- IDLE LIMITER
28. FITTING- FUEL INLET	56. NEEDLE- IDLE ADJUSTING
	57. SPRING- IDLE ADJ. NEEDLE
	58. MAIN BODY ASSY.

CLEANING

CLEANING MUST BE DONE WITH CARBURETOR DISASSEMBLED. SOAK PARTS LONG ENOUGH TO SOFTEN AND REMOVE ALL FOREIGN MATERIAL. USE A CARBURETOR CLEANING SOLVENT. MAKE CERTAIN THE THROTTLE BORES ARE FREE OF ALL CARBON AND VARNISH DEPOSITS. RINSE OFF IN SUITABLE SOLVENT. BLOW OUT ALL PASSAGES IN CASTINGS WITH COMPRESSED AIR AND CHECK CAREFULLY TO INSURE THOROUGH CLEANING OF OBSCURE AREAS. CAUTION: DO NOT SOAK PARTS CONTAINING RUBBER MATERIAL, PLASTIC FLOAT, CHOKE COIL ASSY, SOLENOIDS, IN CLEANING SOLVENTS.

REASSEMBLY

REASSEMBLE IN REVERSE ORDER OF DISASSEMBLY. NOTE SPECIAL INSTRUCTIONS AND FOLLOW NUMERICAL OUTLINE IN MAKING ADJUSTMENT.

SPECIAL INSTRUCTIONS

IDLE ADJUSTING NEEDLE (56)- TURN IN UNTIL LIGHTLY SEATED, THEN BACK OUT 1 1/2 TURNS. (DO NOT INSTALL LIMITER CAP AT THIS TIME.)

CHECK BALL (44)- 2 BALLS OR USED, ONE AS A WEIGHT

PUMP RETURN SPRING (27)- INSTALL WITH SMALL DIAMETER AGAINST CARBURETOR BOWL.

CHOKE COIL ASSY. (13)- WHEN INSTALLING CAREFULLY LOCATE STAT SPRING LOOP ON PIN OF LEVER.

ADJUSTMENTS

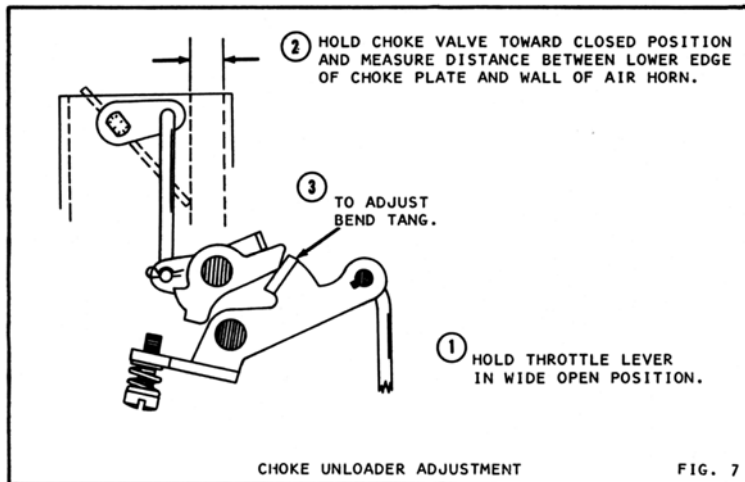
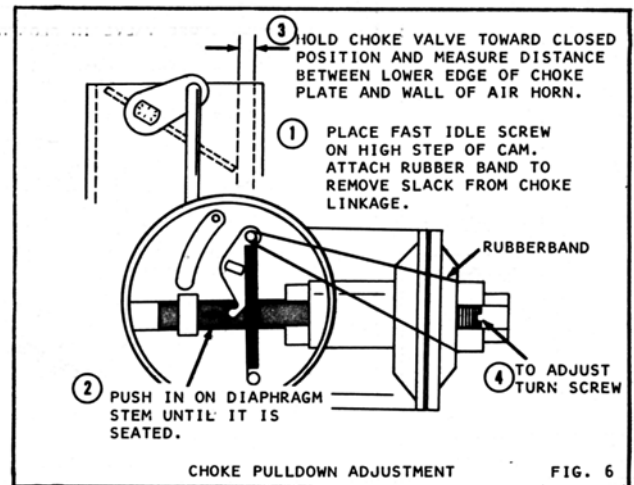
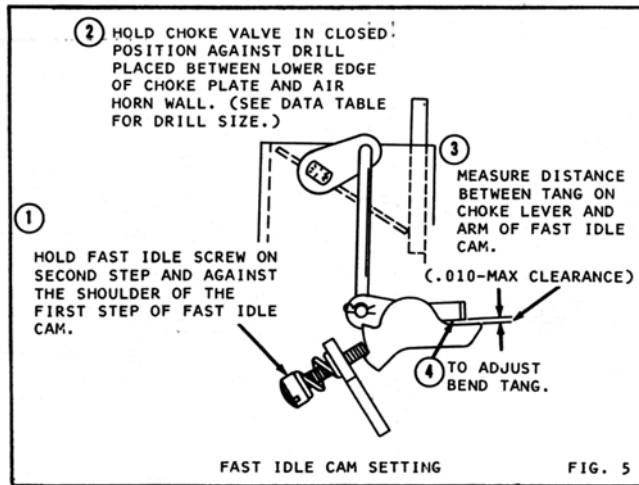
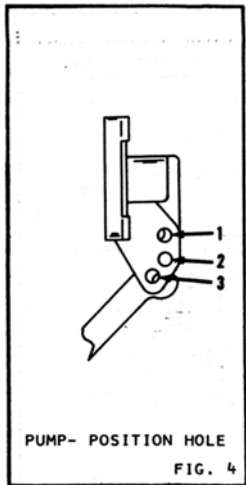
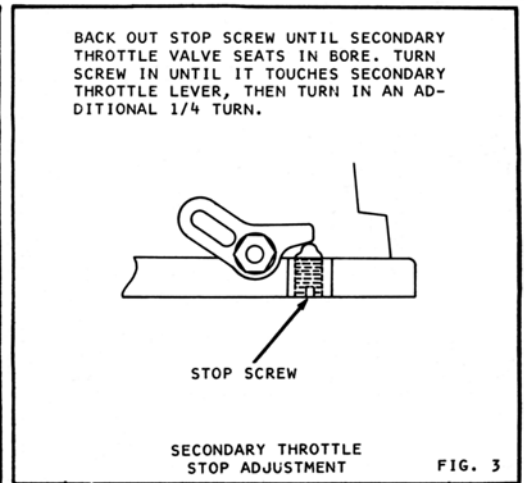
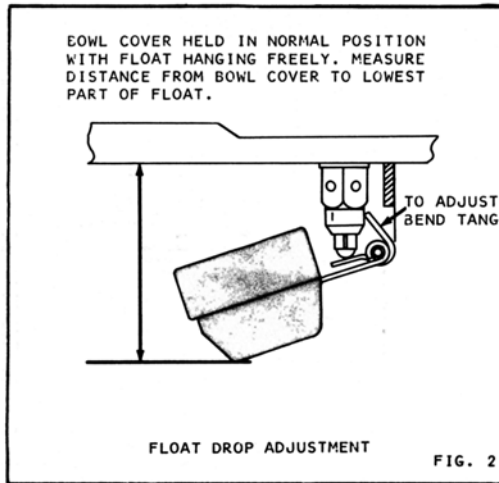
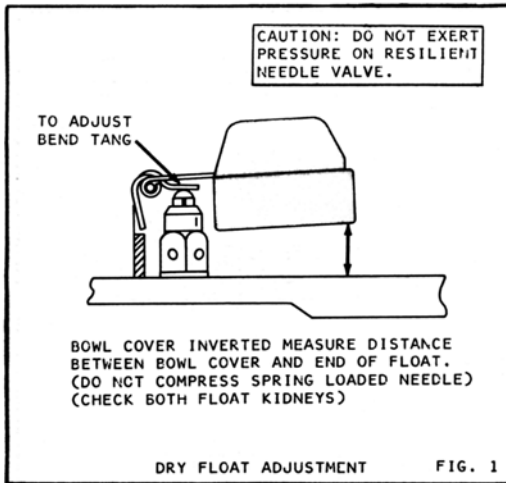

ADJUSTMENT DATA TABLE

YEAR	MAKE	DRY FLOAT LEVEL	FLOAT DROP SETTING	PUMP PIN POSITION	FAST IDLE CAM SETTING	CHOKE PULL DOWN SETTING	UNLOADER SETTING	AUTO CHOKE SETTING	SLOW IDLE R.P.M.	FAST IDLE R.P.M.
1977	BOBCAT, MUSTANG, PINTO, 2.3L ENG. ALTITUDE	M/T	15/32"	1 7/8"	NO. 2	1/8"	1/4"	2-RICH	E/D	**
		A/T	15/32"	1 7/8"	NO. 2	1/8"	1/4"	INDEX	E/D	**
		A/T	15/32"	1 7/8"	NO. 2	1/8"	13/16"	3/16"	INDEX	E/D
	CAPRI 2.3L ENG.	M/T	15/32"	----	NO. 2	1/8"	1/4"	2-RICH	E/D	**
		A/T	15/32"	----	NO. 2	1/8"	1/4"	INDEX	E/D	**

** M/T =1600
1800 W/O EGR
A/T =1800 W/O EGR
E/D =ENGINE DECAL