

INSTRUCTION SHEET

S. U. CARBURETOR - MODEL HIF

GENERAL EXPLODED VIEW

THE GENERAL DESIGN AND PARTS SHOWN WILL VARY TO INDIVIDUAL UNITS COVERED ON THIS INSTRUCTION SHEET

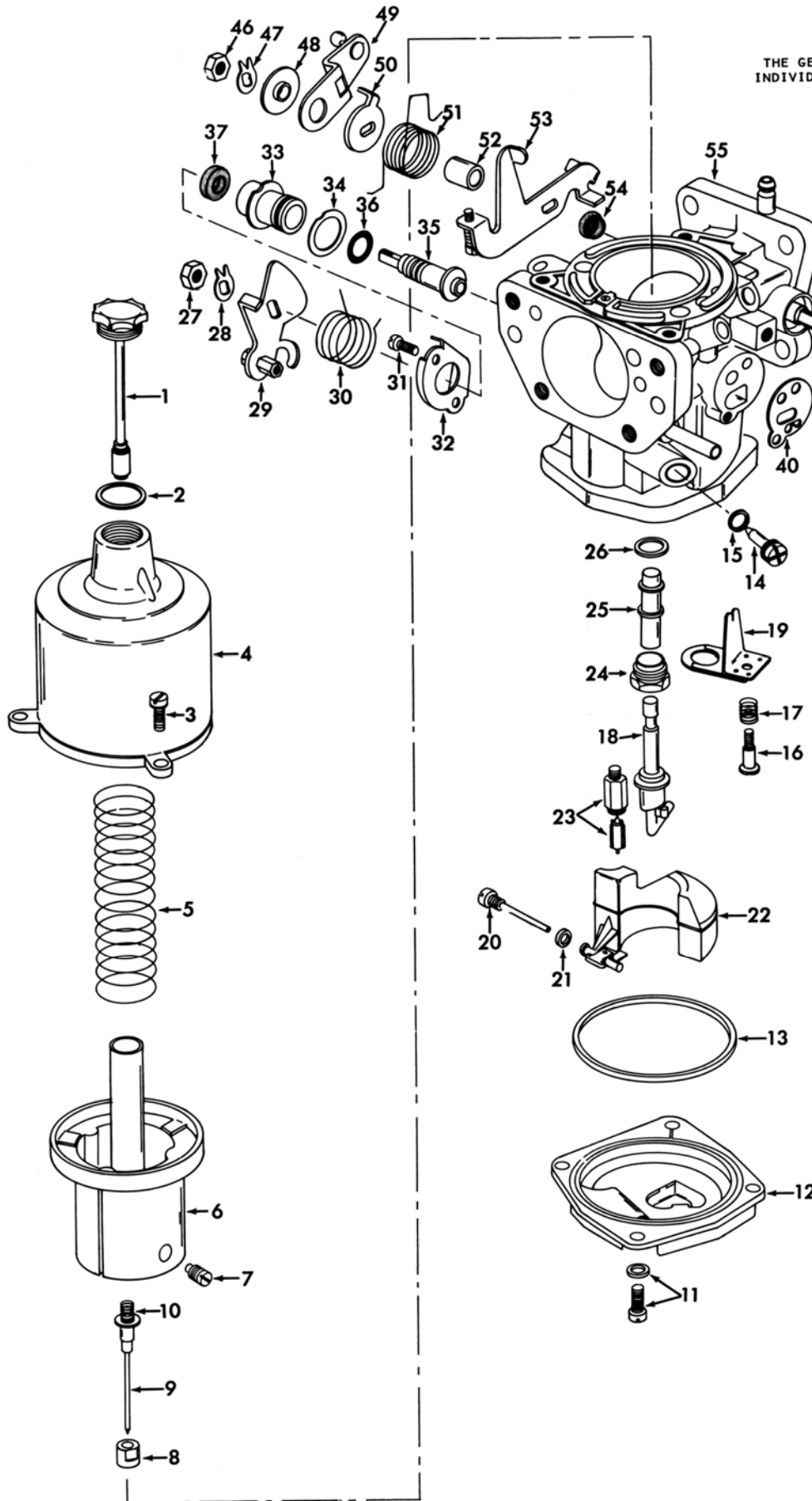

NOMENCLATURE

REF. NO.	DESCRIPTION
1.	PISTON DAMPER
2.	GASKET - PISTON DAMPER
3.	SCREW (3) - SUCTION CHAMBER
4.	CHAMBER - SUCTION
5.	SPRING - PISTON
6.	PISTON ASSY.
7.	SCREW - NEEDLE GUIDE LOCK
8.	GUIDE - NEEDLE
9.	NEEDLE - METERING
10.	SPRING - NEEDLE
11.	SCREW & LOCKWASHER (4) - COVER PLATE
12.	PLATE - BOTTOM COVER
13.	RING SEAL - COVER PLATE
14.	ADJ. SCREW - MIXTURE
15.	O-RING - MIXTURE SCREW
16.	SCREW - ADJ. LEVER
17.	SPRING - ADJ. LEVER SCREW
18.	JET ASSY. - FUEL
19.	BI METAL CONTROL SPRING
20.	PIN & PLUG ASSY. - FLOAT LEVER
21.	GASKET - PIN & PLUG ASSY.
22.	FLOAT & LEVER ASSY.
23.	NEEDLE & SEAT ASSY.
24.	LOCK NUT - JET BEARING
25.	BEARING - JET
26.	GASKET - JET BEARING
27.	NUT - FAST IDLE CAM
28.	LOCK TAB WASHER - NUT
29.	CAM LEVER - FAST IDLE
30.	SPRING - CAM LEVER
31.	SCREW (2) - COLD START BRACKET
32.	BRACKET - COLD START VALVE
33.	VALVE ASSY. - COLD START
34.	GASKET - COLD START VALVE
35.	SPINDLE - VALVE
36.	O-RING - VALVE SEAL
37.	SEAL - VALVE SPINDLE DUST
38.	SCREW & LOCKWASHER (2) - HOT START VALVE
39.	VALVE ASSY. - HOT START
40.	GASKET - VALVE ASSY.
41.	NUT - HOT START LEVER
42.	LOCK TAB WASHER - NUT
43.	LEVER - HOT START
44.	WASHER - SPACER
45.	SEAL - DUST
46.	NUT - THROTTLE LEVER
47.	LOCK TAB WASHER - NUT
48.	WASHER - THROTTLE LEVER
49.	LEVER - THROTTLE
50.	STOP WASHER - LEVER
51.	SPRING - THROTTLE RETURN
52.	COLLAR - SPACER
53.	LEVER - THROTTLE STOP
54.	SEAL - DUST
55.	MAIN BODY ASSY.

ADJUSTMENTS

DISASSEMBLY

USE EXPLODED VIEW AS A GUIDE. THE NUMERICAL SEQUENCE MAY GENERALLY BE FOLLOWED TO DISASSEMBLE UNIT FAR ENOUGH TO PERMIT CLEANING AND INSPECTION. CAUTION: MARK LEVERS AND CHECK LEVER SPRING HOOK UP POINTS BEFORE REMOVING. DUST SEALS (37)(45)(54) MUST BE REMOVED BEFORE CLEANING AND SAVED TO BE USED OVER. SUCTION CHAMBER AND PISTON ASSY. ARE PRECISION MADE AND MUST NOT BE TREATED ROUGHLY.

CLEANING

CLEANING MUST BE DONE WITH CARBURETOR DISASSEMBLED. SOAK PARTS LONG ENOUGH TO SOFTEN AND REMOVE ALL FOREIGN MATERIAL. USE A CARBURETOR CLEANING SOLVENT. MAKE CERTAIN THE THROTTLE BORES ARE FREE OF ALL CARBON AND VARNISH DEPOSITS. RINSE OFF IN SUITABLE SOLVENT. BLOW OUT ALL PASSAGES IN CASTINGS WITH COMPRESSED AIR AND CHECK CAREFULLY TO INSURE THOROUGH CLEANING OF OBSCURE AREAS. CAUTION: DO NOT SOAK PARTS CONTAINING RUBBER OR PLASTIC MATERIALS.

REASSEMBLY

REASSEMBLE IN REVERSE ORDER OF DISASSEMBLY. NOTE SPECIAL INSTRUCTIONS AND FOLLOW NUMERICAL OUTLINE IN MAKING ADJUSTMENTS.

SPECIAL INSTRUCTIONS

PISTON ASSY. (6) - LUBRICATE PISTON ROD LIGHTLY BEFORE INSTALLING (LUBRICATE NO OTHER PART OF PISTON)

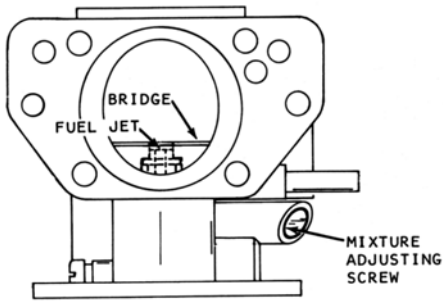
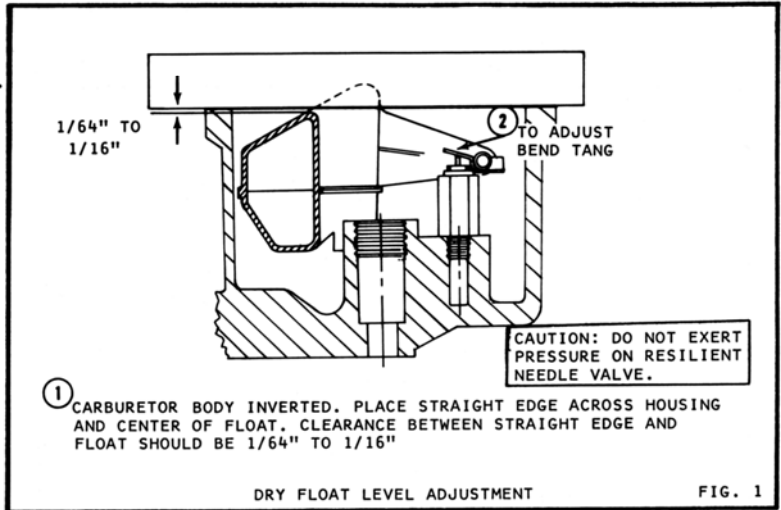

TURN MIXTURE ADJUSTING SCREW IN UNTIL FUEL JET IS LEVEL WITH BRIDGE IN VENTURI. THEN LOWER JET BY BACKING OUT MIXTURE SCREW 2 1/2 TURNS. NOTE: THIS IS BASIC SETTING FOR A CARBURETOR AT 68°F(20°C). IF TEMPERATURE IS ABOVE 68°F(20°C) TURN SCREW LESS THAN 2 1/2 TURNS AND IF LOWER TURN MORE THAN 2 1/2 TURNS.

BASIC FUEL JET ADJUSTMENT

FIG. 2

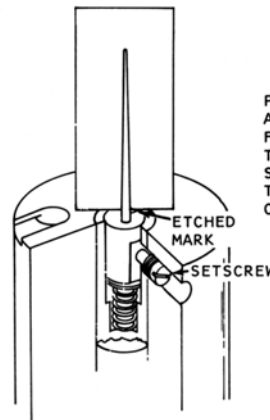

PLACE NEEDLE, SPRING AND GUIDE BUSHING IN AIR VALVE WITH ETCHED MARK POINTING AWAY FROM HOLES IN AIR VALVE OR ON SOME MODELS THE FLAT SIDE OF GUIDE BUSHING ALIGNS WITH SETSCREW. HOLD GUIDE BUSHING FLUSH WITH TOP OF AIR VALVE AND TIGHTEN SETSCREW. CAREFUL NOT TO OVER TIGHTEN SETSCREW.

METERING NEEDLE ADJUSTMENT

FIG. 3

CARBURETOR INSTALLED. FILL THE RESERVOIR WITH LIGHT ENGINE OIL (NO HEAVIER THAN SAE 30). ADD OIL UNTIL OIL LEVEL IS 1/2" ABOVE TOP OF HOLLOW PISTON ROD.

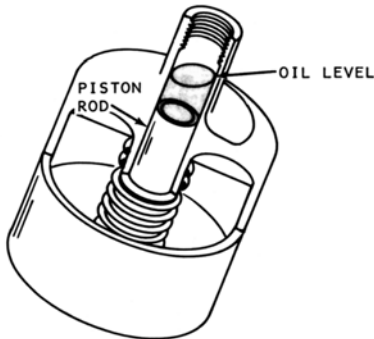

CARBURETOR LUBRICATION

FIG. 4

1 ADJUST IDLE TO CAR MANUAL SPECIFICATIONS.

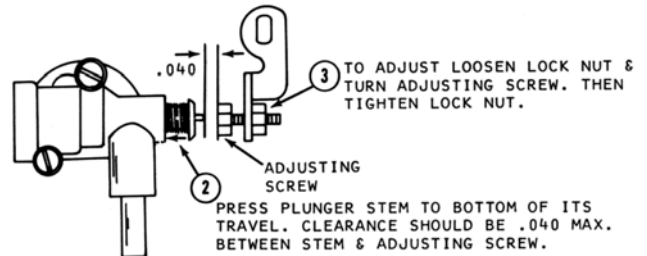

HOT START VAL ADJUSTMENT

FIG. 5