

INSTRUCTION SHEET

(DATSUN) HITACHI CARBURETOR — MODEL DCH 340

GENERAL EXPLODED VIEW

THE GENERAL DESIGN AND PARTS SHOWN WILL VARY TO
INDIVIDUAL UNITS COVERED ON THIS INSTRUCTION SHEET

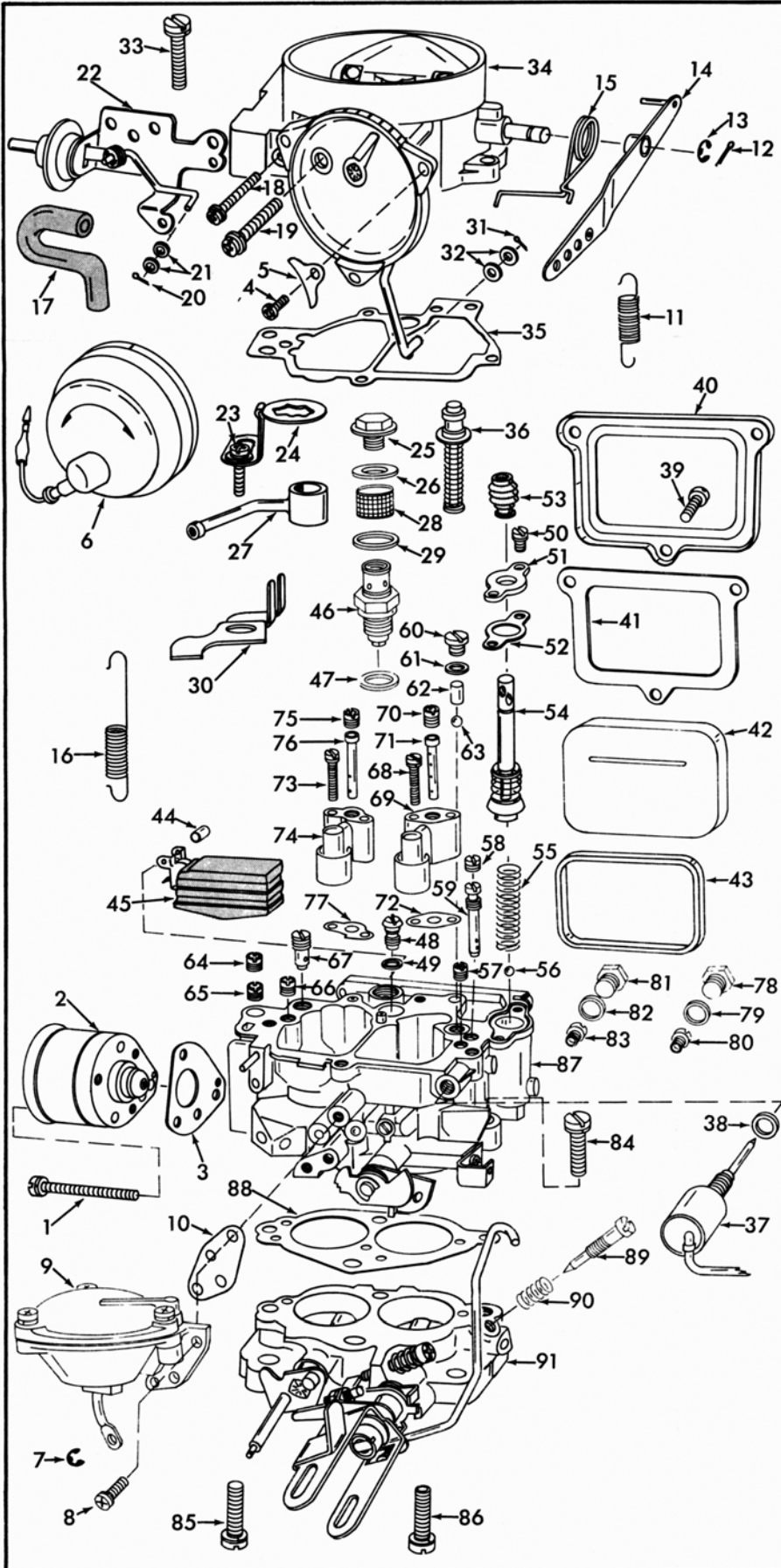

DISASSEMBLY

USE EXPLODED VIEW AS A GUIDE. THE NUMERICAL SEQUENCE MAY GENERALLY BE FOLLOWED TO DISASSEMBLE UNIT FAR ENOUGH TO PERMIT CLEANING AND INSPECTION. **NOTE:** REMOVING VAC. EMISSION UNIT (2), REMOVE ONLY 3 LONGEST SCREWS (1), REMOVE STAKING FROM BOWL COVER FOR EASY REMOVAL OF POWER PISTON ASSY. (36). **NOTE SIZES OF JETS AND THEIR LOCATION FOR PROPER ASSEMBLY.** (RECORD SIZES BELOW) ALSO NOTE LOCATION OF HOLLOW THROTTLE BODY SCREWS (86).

NOMENCLATURE

REF. NO.	REF. NO.
1. SCREW & LOCKWASHER (3)-COASTING VALVE	48. POWER VALVE ASSY.
2. COASTING VALVE ASSY.	49. GASKET-POWER VALVE
3. GASKET-COASTING VALVE	50. SCREW & LOCKWASHER (2)-PUMP PLATE
4. SCREW (3)-CHOKE COVER RETAINER	51. PLATE-PUMP
5. RETAINER (3)-CHOKE COVER	52. GASKET-PUMP PLATE
6. CHOKE COVER ASSY.	53. BOOT-PUMP
7. E-CLIP-SEC. DIAPH. LINK	54. PUMP ASSY.
8. SCREW & LOCKWASHER (3)-SEC. DIAPH. ASSY.	55. SPRING-PUMP RETURN
9. SECONDARY DIAPH. ASSY.	56. BALL-PUMP INTAKE CHECK BLEED
10. GASKET-SEC. DIAPH. ASSY.	57. JET-PRI. SLOW AIR
11. SPRING-PUMP LEVER RETURN	58. PUMP-PRI. SLOW JET
12. COTTER PIN-PUMP LEVER	59. JET-PRI. SLOW
13. E-CLIP-PUMP LEVER	60. PLUG-PUMP DISC. PASSAGE
14. LEVER-PUMP	61. GASKET-PLUG
15. SPRING-PUMP LEVER	62. WEIGHT-PUMP DISC. BALL
16. SPRING-SEC. LEVER RETURN	63. BALL-PUMP DISC.
17. HOSE-VAC. BREAK	64. JET-COASTING AIR BLEED
18. SCREW & LOCKWASHER-CHOKE HOUSING	55. JET-COASTING
19. SCREW & LOCKWASHER-CHOKE HOUSING	66. JET-SEC. SLOW AIR BLEED
20. COTTER PIN-VAC. BREAK LINK	67. JET-SEC. SLOW
21. WASHER (2)-VAC. BREAK LINK	68. SCREW & WASHERS(2)-PRI. VENTURI
22. VACUUM BREAK & LINK ASSY.	69. PRIMARY VENTURI ASSY.
23. SCREW & WASHERS-BANJO BOLT LOCK	70. JET-PRI. MAIN AIR BLEED
24. LOCK-BANJO BOLT	71. TUBE-PRI. EMULSION
25. BOLT-FUEL INLET BANJO	72. GASKET-PRI. VENTURI ASSY.
26. GASKET-BANJO (UPPER)	73. SCREW & WASHERS (2)-SEC. VENTURI
27. BANJO-FUEL INLET	74. SECONDARY VENTURI ASSY.
28. SCREEN FUEL INLET	75. JET-SEC. MAIN AIR BLEED
29. GASKET-BANJO (LOWER)	76. TUBE-SEC. EMULSION
30. BRACKET-FUEL INLET PIPE	77. GASKET-SEC. VENTURI ASSY.
31. COTTER PIN-FAST IDLE ROD	78. PLUG-PRI. MAIN JET
32. WASHER (2)-FAST IDLE ROD	79. GASKET-PLUG
33. SCREEN & LOCKWASHER(3)-AIR HORN	80. JET-PRI. MAIN
34. AIR HORN ASSY.	81. PLUG-SEC. MAIN JET
25. GASKET-AIR HORN	82. GASKET-PLUG
36. POWER PISTON ASSY.	83. JET-SEC. MAIN
37. SOLENOID-ANTI DIESELING	84. SCREW & LOCKWASHER (1)-THROTTLE BODY
38. GASKET-SOLENOID	85. SCREW & LOCKWASHER (1)-THROTTLE BODY
39. SCREW (3)-WINDOW CLAMP	86. SCREW & LOCKWASHER (2)-THROTTLE BODY (HOLLOW)
40. CLAMP-WINDOW	87. BOWL ASSY.
41. GASKET-WINDOW CLAMP	88. GASKET-THROTTLE BODY
42. WINDOW-FUEL BOWL	89. NEEDLE-IDLE ADJUSTING
43. GASKET-BOWL WINDOW	90. SPRING-IDLE NEEDLE
44. SLEEVE-FLOAT RETAINER	91. THROTTLE BODY ASSY.
45. FLOAT & LEVER ASSY.	
46. NEEDLE & SEAT ASSY.	
47. GASKET (SERVICE)-NEEDLE & SEAT	

CLEANING

CLEANING MUST BE DONE WITH CARBURETOR DISASSEMBLED. SOAK PARTS LONG ENOUGH TO SOFTEN AND REMOVE ALL FOREIGN MATERIAL. USE A CARBURETOR CLEANING SOLVENT. MAKE CERTAIN THE THROTTLE BODY IS FREE OF ALL CARBON DEPOSITS. WASH OFF IN SUITABLE SOLVENT. BLOW OUT ALL PASSAGES IN CASTINGS WITH COMPRESSED AIR AND CHECK CAREFULLY TO INSURE THOROUGH CLEANING OF OBSCURE AREAS. **CAUTION:** DO NOT SOAK CHOKE COVER (6), DIAPHRAGM ASSEMBLIES (2) (9) (22) SOLENOID (37) FLOAT (45) OR PARTS MADE OF RUBBER IN ANY TYPE OF CLEANING SOLVENT.

REASSEMBLY

REASSEMBLE IN REVERSE ORDER OF DISASSEMBLY. NOTE: SPECIAL INSTRUCTIONS AND ADJUSTMENTS.

SPECIAL INSTRUCTIONS

IDLE ADJUSTING NEEDLE (89)-TURN NEEDLE IN UNTIL LIGHTLY SEATED THEN BACK OUT 1 3/4 TO 2 TURNS.

PUMP RETURN SPRING (55)-INSTALL WITH CROSS WIRE IN SLOT AT BOTTOM OF PUMP CYLINDER.

PUMP PLUNGER (54)-REMOVE PROPER SLEEVE FROM LEATHER CUP IF USED. FLEX LEATHER OUTWARD SLIGHTLY. SOAK CUP IN LIGHT OIL A FEW MINUTES PRIOR TO PLACING IN CARBURETOR.

NEEDLE AND SEAT (46)-INSTALL GASKET (47) ON SERVICE NEEDLE AND SEAT.

WINDOW CLAMP SCREWS (39)-TIGHTEN SCREWS DOWN EVENLY DON'T OVERTIGHTEN.

POWER PISTON (36)-AFTER INSTALLATION LIGHTLY RESTAKE CASTING AROUND WASHER.

ADJUSTMENTS

- ① FLOAT BOWL INVERTED, MEASURE DISTANCE BETWEEN FLOAT AT TOE END AND CASTING SURFACE. CAUTION: DO NOT PLACE GAUGE UNDER SEAM IN CENTER OF FLOAT.

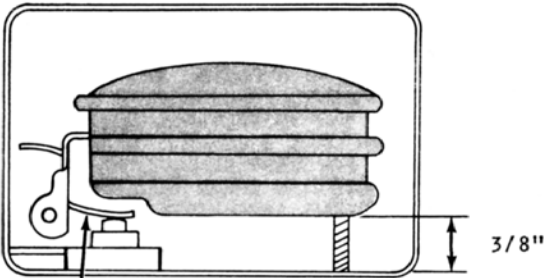

- ② TO ADJUST BEND TANG

CAUTION: DO NOT EXERT PRESSURE ON RESILIENT NEEDLE VALVE.

SOLID NEEDLE
DRY FLOAT LEVEL ADJUSTMENT

FIG. 1.

- ① FLOAT BOWL INVERTED, LIFT FLOAT FULLY UP. MEASURE DISTANCE BETWEEN FLOAT TANG AND NEEDLE VALVE STEM. (DO NOT COMPRESS STEM INTO NEEDLE.)

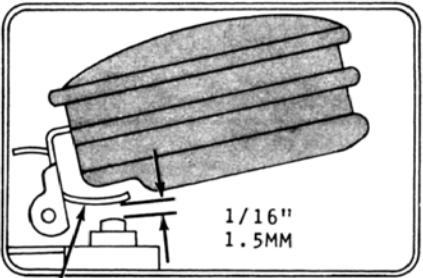

- ② TO ADJUST BEND TANG

CAUTION: DO NOT EXERT PRESSURE ON RESILIENT NEEDLE VALVE.

SPRING LOADED NEEDLE
DRY FLOAT LEVEL ADJUSTMENT

FIG. 2.