

INSTRUCTION SHEET

AISAN CARBURETOR

50-423-2

GENERAL EXPLODED VIEW

THE GENERAL DESIGN AND PARTS SHOWN WILL VARY TO INDIVIDUAL UNITS COVERED ON THIS INSTRUCTION SHEET.

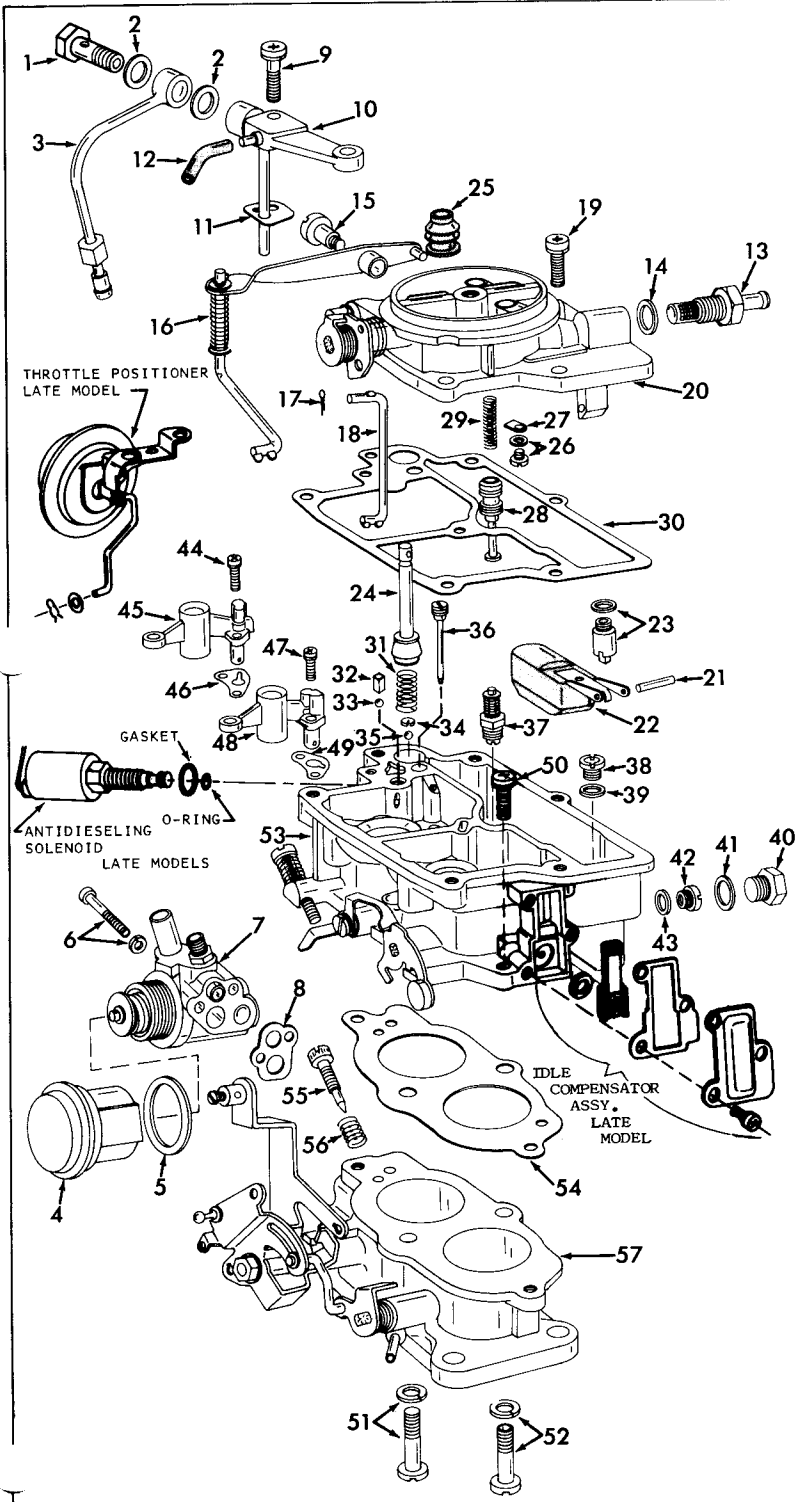

DISASSEMBLY

USE EXPLODED VIEW AS A GUIDE. THE NUMERICAL SEQUENCE MAY GENERALLY BE FOLLOWED TO DISASSEMBLE UNIT FAR ENOUGH TO PERMIT CLEANING AND INSPECTION.

NOMENCLATURE

REF. NO.	NOMENCLATURE	REF. NO.	NOMENCLATURE
1.	BOLT -FUEL PIPE	30.	GASKET - BOWL COVER
2.	GASKET (2)-FUEL PIPE BOLT	31.	SPRING - PUMP RETURN
3.	PIPE-FUEL	32.	WEIGHT - PUMP DISC. BALL
4.	COVER-A.S.S. VALVE	33.	BALL - PUMP DISC. (LARGE)
5.	GASKET - COVER	34.	RETAINER - INTAKE BALL
6.	SCREW & LOCKWASHER (2)-A.S.S. VALVE	35.	BALL - INTAKE CHECK (SMALL)
7.	A.S.S. VALVE ASSY.	36.	JET - IDLE
8.	GASKET - A.S.S. VALVE	37.	POWER VALVE ASSY.
9.	SCREW & LOCKWASHER (2)-ADAPTOR	38.	JET - SECONDARY (CROME)
10.	ADAPTOR ASSY.	39.	GASKET - SECONDARY JET
11.	GASKET - ADAPTOR	40.	PLUG - PRIMARY JET
12.	TUBE - ADAPTOR	41.	GASKET - PLUG
13.	STRAINER ASSY.	42.	JET - PRIMARY (BRASS)
14.	GASKET - STRAINER ASSY.	43.	GASKET - PRIMARY JET
15.	SCREW - PUMP LEVER	44.	SCREW & LOCKWASHER (2)-PRIMARY VENTURI
16.	LEVER & CONNECTING ROD ASSY. - PUMP	45.	VENTURI - PRIMARY
17.	COTTER PIN - FAST IDLE ROD	46.	GASKET - PRIMARY VENTURI
18.	ROD - FAST IDLE	47.	SCREW & LOCKWASHER (2)-SECONDARY VENTURI
19.	SCREW & LOCKWASHER (4)-BOWL COVER	48.	VENTURI - SECONDARY
20.	BOWL COVER ASSY.	49.	GASKET - SECONDARY VENTURI
21.	PIN - FLOAT LEVER	50.	SCREW & LOCKWASHER (2)-BOWL TO THROTTLE BODY
22.	FLOAT & LEVER ASSY.	51.	SCREW & LOCKWASHER (1)-THROTTLE BODY TO BOWL
23.	NEEDLE, SEAT & GASKET ASSY.	52.	SCREW & LOCKWASHER (1)-THROTTLE BODY TO BOWL (HOLLOW)
24.	PUMP PLUNGER ASSY.	53.	BOWL ASSY.
25.	BOOT - PUMP	54.	GASKET - THROTTLE BODY
26.	SCREW & LOCKWASHER - PISTON RETAINER	55.	NEEDLE - IDLE ADJUSTING
27.	RETAINER - PISTON	56.	SPRING - IDLE ADJUSTING NEEDLE
28.	PISTON - POWER	57.	THROTTLE BODY ASSEMBLY
29.	SPRING - POWER PISTON		

CLEANING

CLEANING MUST BE DONE WITH CARBURETOR DISASSEMBLED. SOAK PARTS LONG ENOUGH TO SOFTEN AND REMOVE ALL FOREIGN MATERIAL. USE A CARBURETOR CLEANING SOLVENT. MAKE CERTAIN THE THROTTLE BODY IS FREE OF ALL HARD CARBON DEPOSITS. WASH OFF IN SUITABLE SOLVENT. BLOW OUT ALL PASSAGES IN CASTINGS WITH COMPRESSED AIR AND CHECK CAREFULLY TO INSURE THOROUGH CLEANING OF OBSCURE AREAS. CAUTION: DO NOT SOAK ANY OF THE FOLLOWING PARTS IN CLEANING SOLVENTS. PARTS MADE OF RUBBER, DIAPHRAGM ASSY. (4), FLOAT (22), IDLE COMPENSATOR VALVE ASSY., ANTIDIESELING SOLENOID, OR THROTTLE POSITIONER.

REASSEMBLY

REASSEMBLE IN REVERSE ORDER OF DISASSEMBLY. NOTE: SPECIAL INSTRUCTIONS AND ADJUSTMENTS.

SPECIAL INSTRUCTIONS

IDLE ADJUSTING NEEDLE (55) -TURN NEEDLE IN UNTIL LIGHTLY SEATED, THEN BACK OUT 2 TURNS.

PUMP PLUNGER (24) - REMOVE PAPER SLEEVE FROM LEATHER CUP IF USED, FLEX LEATHER OUTWARD SLIGHTLY. SOAK CUP IN GASOLINE, KEROSENE OR OIL FOR A FEW MINUTES PRIOR TO PLACING IN CARBURETOR.

A.S.S. VALVE (7) - BEFORE INSTALLING COVER (4) APPLY A SEALER ON THREADS NEAR GASKET SEAT.

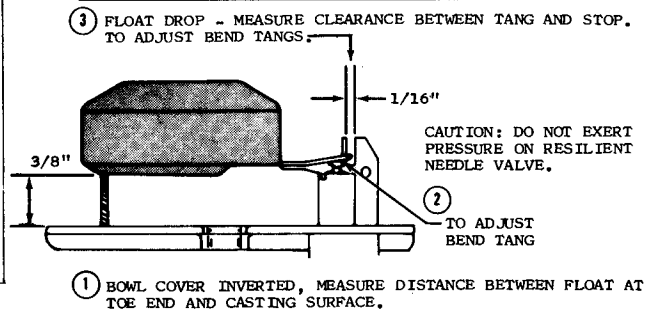

DRY FLOAT LEVEL ADJUSTMENT

① BOWL COVER INVERTED, MEASURE DISTANCE BETWEEN FLOAT AT TOE END AND CASTING SURFACE.

③ FLOAT DROP - MEASURE CLEARANCE BETWEEN TANG AND STOP. TO ADJUST BEND TANGS.

CAUTION: DO NOT EXERT PRESSURE ON RESILIENT NEEDLE VALVE.

② TO ADJUST BEND TANG