

# INSTRUCTION SHEET

## FORD CARBURETOR—MODEL F-2

### GENERAL EXPLODED VIEW

THE GENERAL DESIGN AND PARTS SHOWN WILL VARY TO INDIVIDUAL UNITS COVERED ON THIS INSTRUCTION SHEET

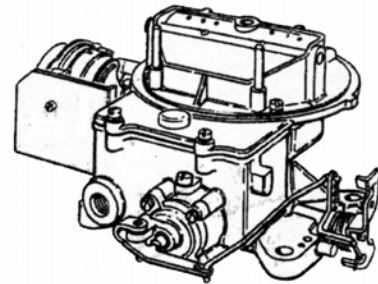

### DISASSEMBLY

USE EXPLODED VIEW AS A GUIDE. THE NUMERICAL SEQUENCE MAY GENERALLY BE FOLLOWED TO DISASSEMBLE UNIT FAR ENOUGH TO PERMIT CLEANING AND INSPECTION. NOTE: TO REMOVE SLEEVE (57) FROM STEM OF DIAPHRAGM (59) ON 1957 MODELS, COMPRESS SLEEVE (57) AND SPRING (58), SO BALL (56) CAN DROP OUT OF HOLE. THE SLEEVE AND SPRING WILL THEN SLIDE OFF DIAPHRAGM SHAFT.

### NOMENCLATURE

REF. NO.	REF. NO.
1. RETAINER-CHOKE ROD LOWER	33. DASHPOT
2. STUD-AIR CLEANER	34. BRACKET-DASHPOT
3. SCREW-BOWL COVER	35. SCREW-INLET CHECK BALL RETAINER
4. BOWL COVER ASSY.	36. GASKET-INLET CHECK BALL RETAINER SCREW
5. GASKET-BOWL COVER	37. BALL-PUMP INLET CHECK
6. SCREW-PUMP DISCHARGE NOZZLE	38. RETAINER-PUMP ROD
7. GASKET-PUMP DISCHARGE NOZZLE SCREW	39. PUMP ROD
7A PLATE (AIR DISTRIBUTION)-PUMP DISCHARGE NOZZLE. LATE 1964 & 1965 PARTIAL PRODUCTION	40. SCREW & LOCKWASHER-PUMP COVER
8. WEIGHT-DISCHARGE CHECK BALL	41. PUMP COVER & LEVER ASSY.
9. BALL-DISCHARGE CHECK	42. PUMP DIAPHRAGM ASSY.
10. VENTURI CLUSTER ASSY.	43. SPRING-PUMP DIAPHRAGM RETURN
11. GASKET-VENTURI CLUSTER ASSY.	44. CAVITY FILLER-PUMP
12. RETAINER-FLOAT PIN	45. SCREW & LOCKWASHER-ECONOMIZER VALVE COVER
13. SPRING-FLOAT DAMPER	46. COVER-ECONOMIZER VALVE
14. PIN-FLOAT HINGE	47. GASKET-ECONOMIZER VALVE COVER
15. FLOAT & LEVER ASSY.	48. VALVE-ECONOMIZER
16. NEEDLE, SEAT & GASKET ASSY.	49. GASKET-ECONOMIZER VALVE
17. JETS-MAIN METERING	50. NEEDLES-IDLE ADJUSTING
18. SCREW & LOCKWASHER-AIR SHIELD	51. SPRINGS-IDLE ADJUSTING NEEDLE
19. AIR SHIELD	52. FITTING-FUEL INLET
20. SCREW & LOCKWASHER-STAT CLAMP	53. GASKET-FUEL INLET FITTING
21. CLAMP-STAT COVER	54. SCREEN-FUEL INLET FILTER
22. STAT COVER & SPRING ASSY.	55. PUMP COVER & LEVER ASSY.-1957
23. GASKET-STAT COVER	56. BALL-PUMP PUSH ROD SLEEVE-1957
24. PLATE-CHOKE BAFFLE	57. SLEEVE-PUMP PUSH ROD-1957
25. RETAINER-FAST IDLE ROD UPPER	58. SPRING-PUMP PUSH ROD-1957
26. WASHER-FAST IDLE ROD UPPER	59. PUMP DIAPHRAGM ASSY.-1957
27. RETAINER-FAST IDLE ROD LOWER	60. SPRING-PUMP DIAPHRAGM RETURN-1957
28. FAST IDLE ROD	61. PUMP COVER & LEVER ASSY.
29. SCREW & LOCKWASHER-CHOKE HOUSING	62. PUMP DIAPHRAGM ASSY.
30. CHOKE HOUSING ASSY.	63. SPRING-PUMP DIAPHRAGM RETURN
31. GASKET-CHOKE HOUSING ASSY.	64. VALVE-PUMP INLET CHECK
32. LOCKNUT-DASHPOT	65. PUSH ROD-PUMP DIAPHRAGM

### CLEANING

CLEANING MUST BE DONE WITH CARBURETOR DISASSEMBLED. SOAK PARTS LONG ENOUGH TO SOFTEN AND REMOVE ALL FOREIGN MATERIAL. USE (1) A CARBURETOR CLEANING SOLVENT, (2) LACQUER THINNER OR (3) DENATURATED ALCOHOL. MAKE CERTAIN THE THROTTLE BODY IS FREE OF ALL HARD CARBON DEPOSITS. WASH OFF IN SUITABLE SOLVENT. BLOW OUT ALL PASSAGES IN CASTINGS WITH COMPRESSED AIR AND CHECK CAREFULLY TO INSURE THOROUGH CLEANING OF OBSCURE AREAS.

CAUTION: DO NOT SOAK ANY PARTS CONTAINING RUBBER, LEATHER OR PLASTIC IN CLEANING SOLVENT.

### REASSEMBLY

REASSEMBLE IN REVERSE ORDER OF DISASSEMBLY. NOTE SPECIAL INSTRUCTIONS AND FOLLOW NUMERICAL OUTLINE IN MAKING ADJUSTMENTS. SEE OTHER SIDE.

### SPECIAL INSTRUCTIONS

WHEN INSTALLING IDLE MIXTURE ADJUSTING NEEDLES (50), LIGHTLY BOTTOM THEM BACK OUT 1 1/2 TURNS.

ECONOMIZER VALVE (48). USE CARE WHEN TIGHTENING TO PREVENT DISTORTION OF GASKET (49).

1960 AND LATER MODELS HAVE A WEIGHT (8) ON TOP OF THE DISCHARGE PUMP CHECK BALL (9), LOCATED UNDER PUMP DISCHARGE NOZZLE SCREW (6).

PUMP DIAPHRAGM ASSEMBLY 1957 MODELS. SLIDE SPRING (58) AND SLEEVE (57) ON THE STEM, ROTATE SLEEVE UNTIL HOLE IS ALIGNED WITH NOTCH IN STEM, THEN DROP BALL INTO HOLE AND GENTLY RELEASE PRESSURE ON SLEEVE.

STAT COVER (22) INSTALLATION. BE SURE SPRING LOOP IS HOOKED ONTO TANG OF CHOKE LEVER OR IN SLOT OF LEVER ON LATE MODELS.

PUMP DIAPHRAGM ASSEMBLY (62) AND PUMP DIAPHRAGM PUSH ROD (65) WILL REPLACE PUMP DIAPHRAGM ASSEMBLY (42).

PUMP INLET CHECK VALVE (64) INSTALLATION. LUBRICATE TIP OF NEW VALVE AND INSERT IN CENTER HOLE OF PUMP CAVITY. USE NEEDLE NOSE PLIERS AND PULL THRU FROM FUEL BOWL SIDE UNTIL FULLY SEATED. CUT OFF VALVE TIP AT RETAINING SHOULDER.

PUMP DIAPHRAGM RETURN SPRING (63) INSTALLATION - INSTALL LARGE OPEN END OF SPRING OVER RUBBER INLET CHECK VALVE.

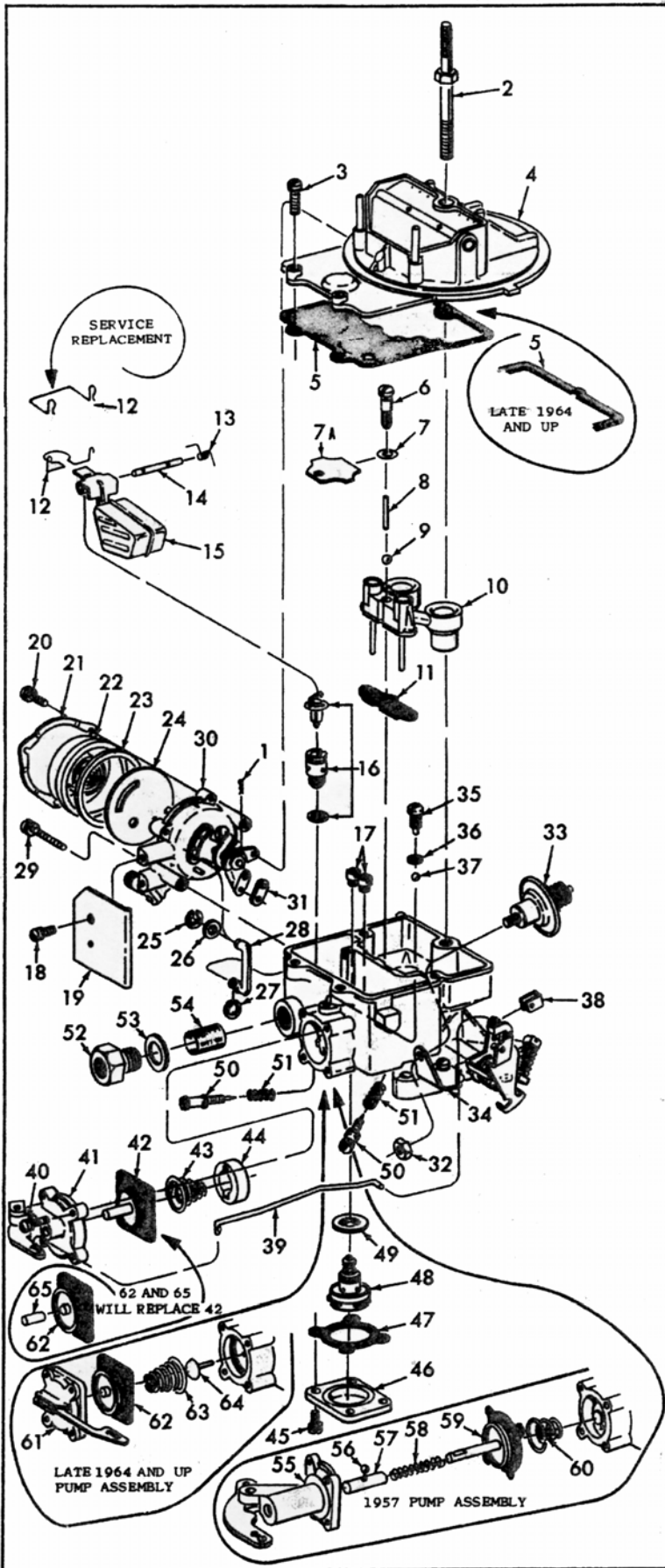

# ADJUSTMENTS

CAUTION: DO NOT EXERT PRESSURE ON RESILIENT NEEDLE VALVE

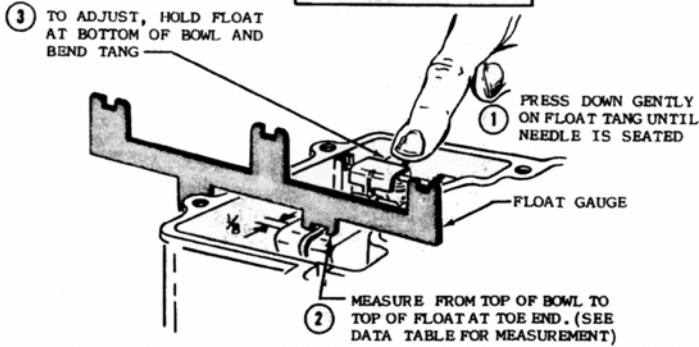

FLOAT LEVEL ADJUSTMENT

Fig.1

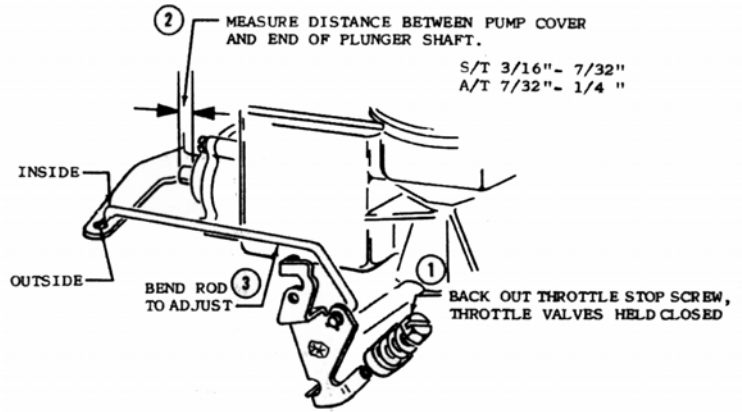

PUMP ADJUSTMENT TYPE "A"

Fig.2

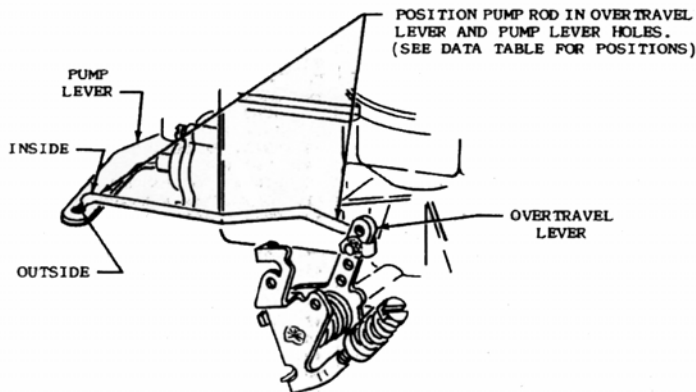

PUMP ADJUSTMENT TYPE "B"

Fig.3

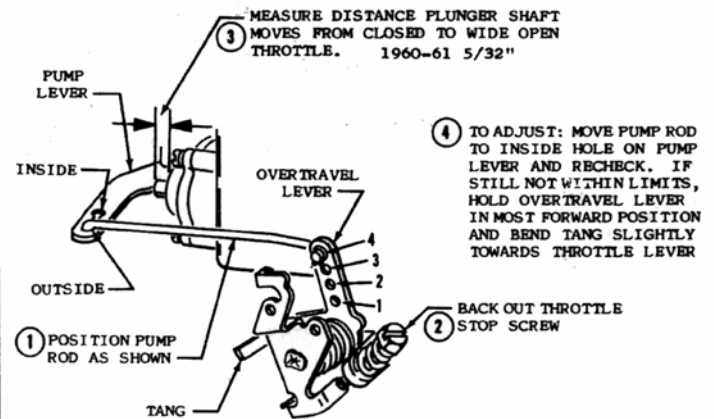

PUMP ADJUSTMENT TYPE "C"

Fig.4

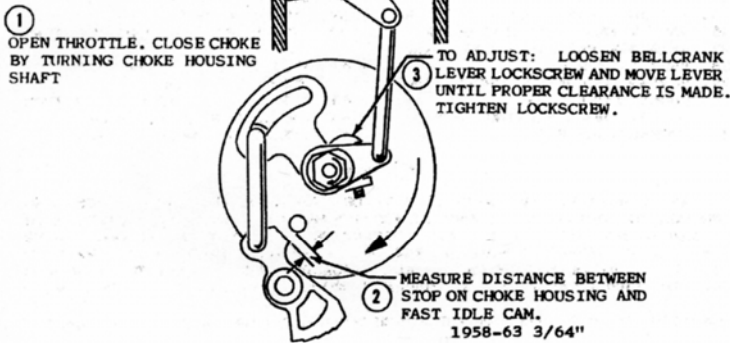

BELLCRANK ADJUSTMENT

Fig.5

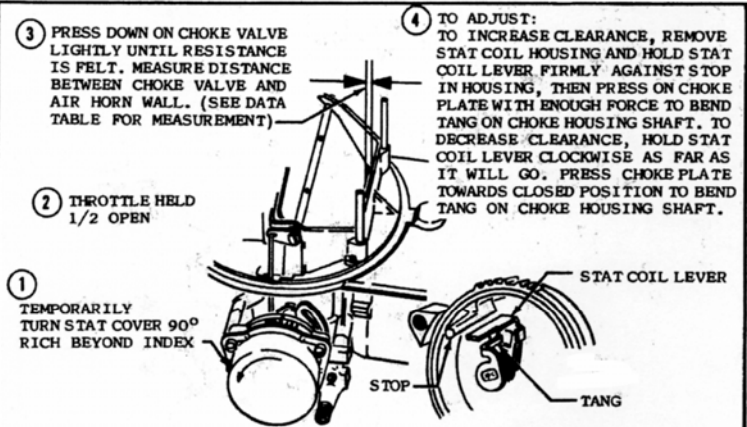

1960-61  
CHOKE VALVE PULLDOWN ADJUSTMENT

Fig.6

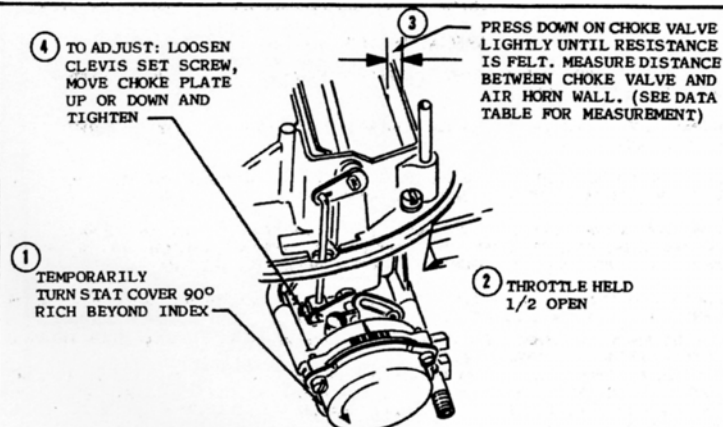

1962-63  
CHOKE VALVE PULLDOWN ADJUSTMENT

Fig.7

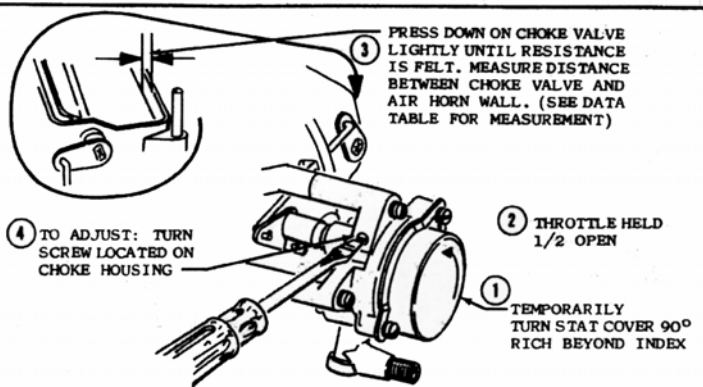

1964 & UP  
(MECHANICAL LINKAGE AUTOMATIC CHOKE)  
CHOKE VALVE PULLDOWN ADJUSTMENT

Fig.8

